



For more free Copeland literature please visit

[www.HVACRinfo.com](http://www.HVACRinfo.com)

# Copeland Screw™ Compressors Replacement Parts Guide

Model Families: SCH, SCA, SHL,  
SHM, SDL, SDM



**EMERSON**<sup>™</sup>  
Climate Technologies

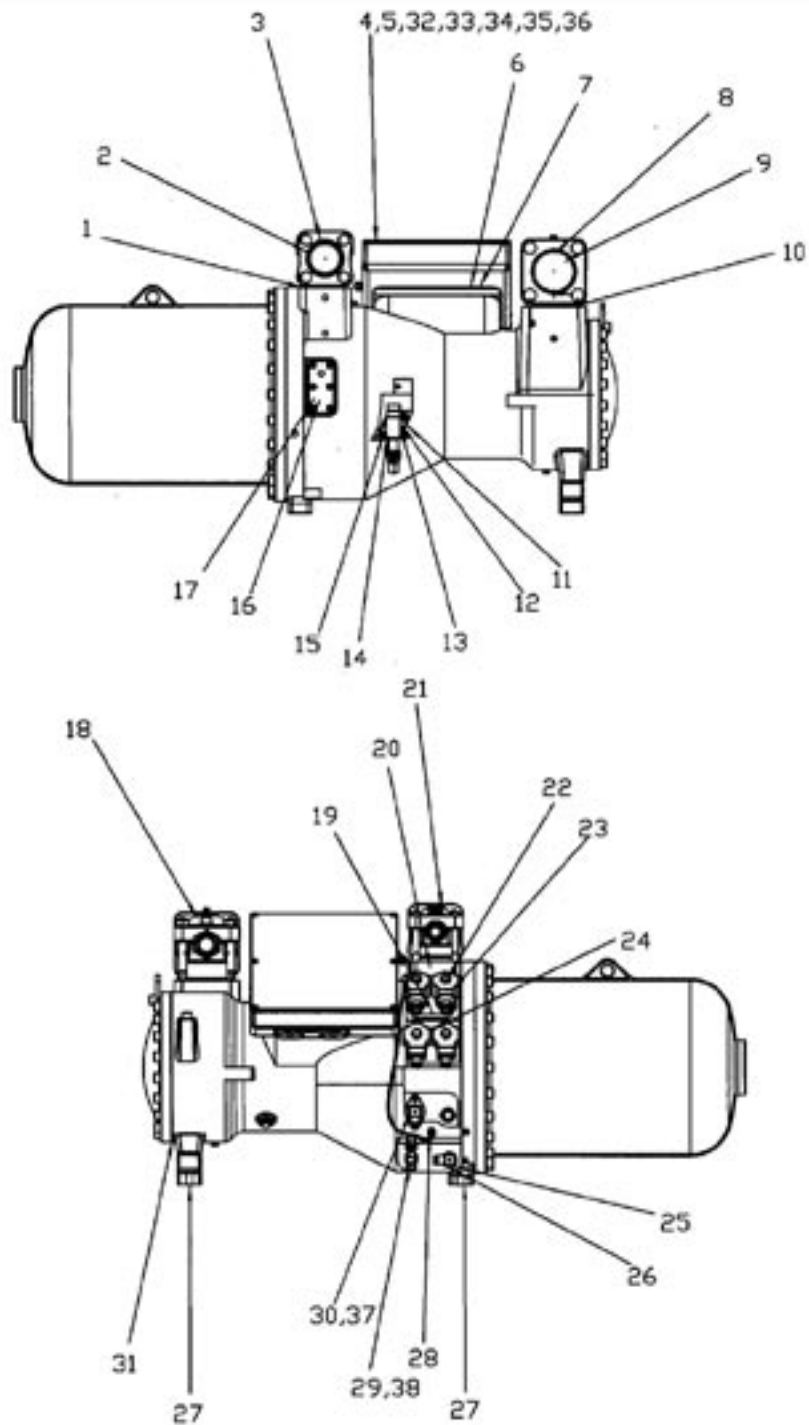
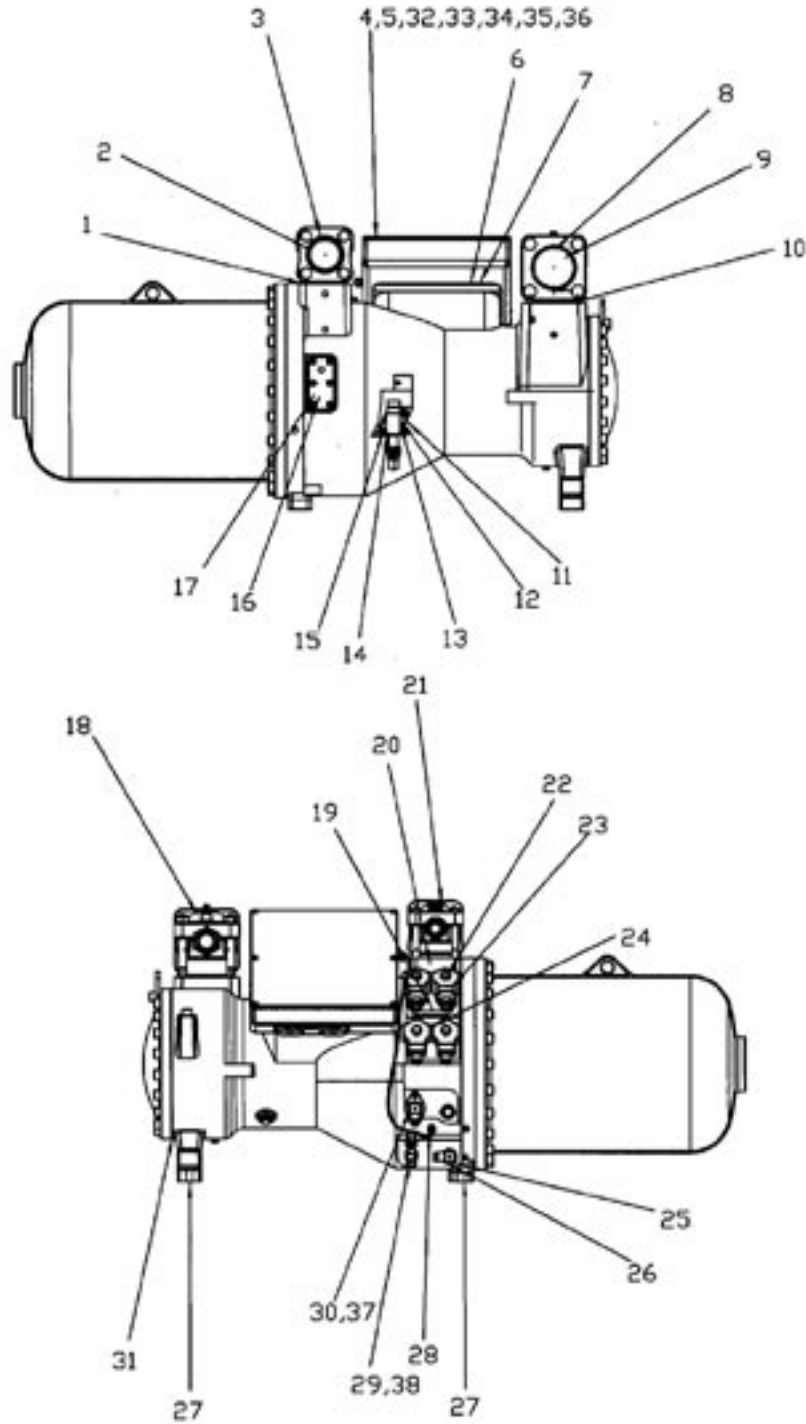

**Figure 1**  
 SCH2 Series Compressors  
 SCA2 Series Compressors

**SCH2-5000 SCA2-350E**  
**SCH2-6000 SCA2-400E**

**See Figure 1**

<b>Item #</b>	<b>Description</b>	<b>Copeland Part #</b>
1	Discharge Valve and Solder Bushing Gasket	020-0983-08
2	Joint Ring Gasket for Discharge Valve	020-0983-08
3	1-5/8" Discharge Valve Solder Bushing	036-0724-18
4	Terminal Box	062-0261-00
5	Terminal Box Cover	005-1019-00
5a	Terminal Box Cover Screw	100-0337-00
6	Terminal Plate Assembly	521-0213-00
7	Terminal Plate Gasket	020-1091-00
8	2-1/8" Suction Valve Solder Bushing	036-0832-00
9	Joint Ring Gasket for Suction Valve	020-0983-09
10	Suction Valve and Solder Bushing Gasket	020-0983-06
11	Liquid Injection/Eco Fitting M22 x 1-1/4-12 UNF	536-0724-12
12	Liquid Injection/Eco Fitting M22 Aluminum Washer	102-0147-00
13	Liquid Injection/Eco Fitting M22 x 5/8 Flare	536-0724-11
14	New Style Liquid Injection Nozzle 1-1/4-12 UNF Roto-Lock	036-0724-27
15	New Style Eco Fitting/Eco Pulsation Muffler M22 x 1-1/4-12 UNF	019-0082-00
16	External Oil Cooling Adapter Plate	034-0115-00
17	Gasket for External Oil Cooling Adapter Plate	020-1069-00
18	2-1/8" Suction Valve	510-0428-03
18a	2-1/8" Suction Valve Kit (includes Valve, Gaskets, Bolts)	510-0428-14
19	Unloader Base Plate Gasket	020-1066-00
20	Discharge Check Valve Kit	510-0501-00
21	1-5/8" Discharge Valve	510-0428-02
21a	1-5/8" Discharge Valve Kit (includes Valve, Gaskets, Bolts)	510-0428-15
22	Unloader Flange	510-0428-12
23	24 Volt AC Unloader Solenoid Coil - 5/8"	023-0008-03
23	115 Volt Unloader Solenoid Coil - 5/8"	023-0008-00
23	230 Volt Unloader Solenoid Coil - 5/8"	023-0008-01
24	Unloader Flange Gasket	020-0983-22
25	Oil Sightglass Gasket	020-1068-00
26	200 Watt Crankcase Heater 115 Volt	018-0055-04
26	200 Watt Crankcase Heater 230 Volt	018-0055-05
27	Vibration Damper Kit	560-0005-00
28	Oil / Discharge Temp Sensor	085-0164-00
29	Oil Drain / Fill Valve	010-0049-07
30	Oil Level Control	039-0008-00
31	Stator Cover Gasket	020-1092-00
32	INT69VSY-II 115 Volt Module (Thru Date Code "04E")	071-0549-01
32	INT69VSY-II 230 Volt Module (Thru Date Code "04E")	071-0549-00
32	INT69VSY-II 24 Volt AC Module (Thru Date Code "04E")	071-0549-04
32	SE-S1 115/220 Volt Protection Module (After Date Code "04E")	071-0549-07
32	SE-S1 24 Volt AC Protection Module (After Date Code "04E")	071-0549-08
32	SE-S1 24 Vold DC Protection Module (After Date Code "04E")	071-0549-09
33	Step Down Resistor for INT69VSY-II 575 Volt Appl.	071-0549-05
34	Jumper Bar (3) for DOL Starting	003-0877-04
35	Terminal Box Cover Gasket	020-1093-00
36	12 Position Connector Strip	021-0229-00
37	External Oil Level Control Gasket	020-0006-53
38	M22 Aluminum Washer for Drain Valve	102-0147-00
38a	Teflon O-Ring 3/4" for Oil Drain Valve Fitting	020-0028-01
Not Shown	Compressor Gasket Set	520-0137-00

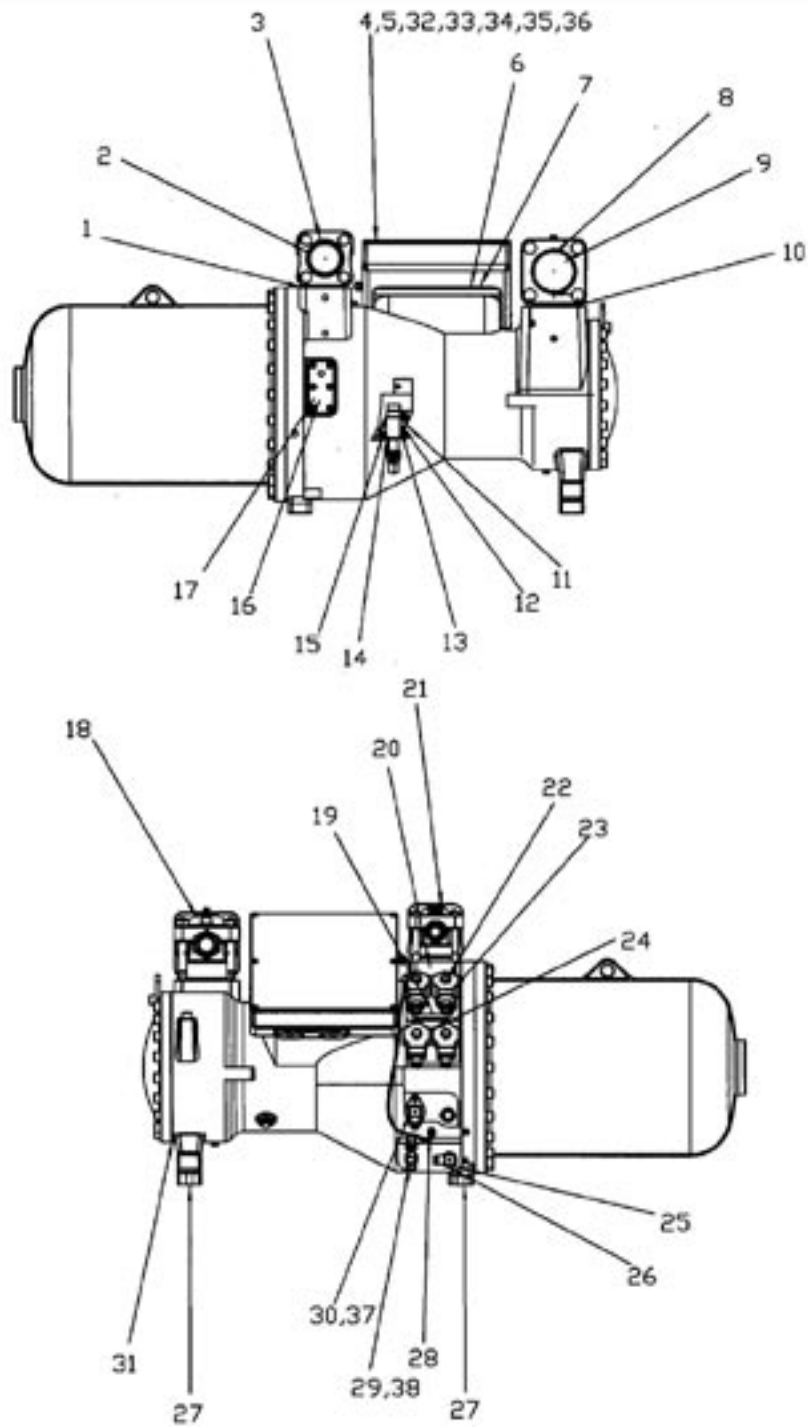

**Figure 2**  
 SCH2 Series Compressors  
 SCA2 Series Compressors

**SCH2-7000 SCA2-500E SCA2-801E**  
**SCH2-8000 SCA2-600E SCA2-901E**  
**SCH2-9000 SCA2-700E**

**See Figure 2**

<b>Item #</b>	<b>Description</b>	<b>Copeland Part #</b>
1	Discharge Valve and Solder Bushing Gasket	020-0983-06
2	Joint Ring Gasket for Discharge Valve	020-0983-09
3	2-1/8" Discharge Valve Solder Bushing	036-0832-00
4	Terminal Box	062-0266-00
5	Terminal Box Cover	005-0929-01
5a	Terminal Box Cover Screw	100-0333-00
6	Terminal Plate Assembly	503-0879-00
7	Terminal Plate Gasket	020-0983-11
8	3-1/8" Suction Valve Solder Bushing	036-0832-02
9	Joint Ring Gasket for Suction Valve	020-0006-62
10	Suction Valve and Solder Bushing Gasket	020-0983-07
11	Liquid Injection/Eco Fitting M22 x 1-1/4-12 UNF	536-0724-12
12	Liquid Injection/Eco Fitting M22 Aluminum Washer	102-0147-00
13	Liquid Injection/Eco Fitting M22 x 5/8 Flare	536-0724-11
14	New Style Liquid Injection Nozzle M22 x 1-1/4-12 UNF Roto-Lock	036-0724-27
15	New Style Eco Fitting/Eco Pulsation Muffler M22 x 1-1/4-12 UNF	019-0082-00
16	External Oil Cooling Adapter Plate	034-0115-00
17	Gasket for External Oil Cooling Adapter Plate	020-1069-00
18	3-1/8" Suction Valve	510-0428-04
18a	3-1/8" Suction Valve Kit (includes Valve,Gaskets,Bolts)	510-0428-11
19	Unloader Base Plate Gasket	020-1066-00
20	Check Valve Kit	510-0428-16
21	2-1/8" Discharge Valve	510-0428-03
21a	2-1/8" Discharge Valve Kit (includes Valve,Gaskets,Bolts)	510-0428-14
22	Unloader Flange	510-0428-12
23	24 Volt AC Unloader Solenoid Coil - 5/8"	023-0008-03
23	115 Volt Unloader Solenoid Coil - 5/8"	023-0008-00
23	230 Volt Unloader Solenoid Coil - 5/8"	023-0008-01
24	Unloader Flange Gasket	020-0983-22
25	Oil Sightglass Gasket	020-1068-00
26	200 Watt Crankcase Heater 115 Volt (12 Inches)	018-0055-00
26	200 Watt Crankcase Heater 230 Volt (12 Inches)	018-0055-01
26	200 Watt Crankcase Heater 115 Volt (6 Inches)	018-0055-06
26	200 Watt Crankcase Heater 230 Volt (6 Inches)	018-0055-07
27	Vibration Damper Kit	527-0183-00
28	Oil / Discharge Temp Sensor	085-0164-00
29	Oil Drain / Fill Valve	010-0049-07
30	Oil Level Control	039-0008-00
31	Stator Cover Gasket	020-1070-00
32	INT69VSY-II 115 Volt Module (Thru Date Code "04E")	071-0549-01
32	INT69VSY-II 230 Volt Module (Thru Date Code "04E")	071-0549-00
32	INT69VSY-II 24 Volt AC Module (Thru Date Code "04E")	071-0549-04
32	SE-S1 115/220 Volt Protection Module (After Date Code "04E")	071-0549-07
32	SE-S1 24 Volt AC Protection Module (After Date Code "04E")	071-0549-08
32	SE-S1 24 Vold DC Protection Module (After Date Code "04E")	071-0549-09
33	Step Down Resistor For INT69VSY-II 575 Volt Appl.	071-0549-05
34	Jumper Bar (3) for DOL Starting	003-0877-02
35	Terminal Box Cover Gasket	020-0983-19
36	12 Position Connector Strip	021-0229-00
37	External Oil Level Control Gasket	020-0006-53
38	M22 Aluminum Washer for Drain Valve	102-0147-00
38a	Teflon O-Ring 3/4" for Oil Drain Valve Fitting	020-0028-01
Not Shown	Compressor Gasket Set	520-0133-00
Not Shown	Insulator for Brass Lugs	021-0258-01
Not Shown	Brass Terminal Lugs	003-0993-02
Not Shown	Brass Lug Metric Screw	100-0302-05
Not Shown	Metric Screw for Insulator/Lug Connection	100-0302-04



**Figure 3**  
 SCH2 Series Compressors  
 SCA2 Series Compressors

**SCH2-11H0**  
**SCH2-12H0**  
**SCH2-14H0**

**SCA2-800E**  
**SCA2-900E**  
**SCA2-11HE**

**SCA2-12HE**  
**SCA2-14HE**

**See Figure 3**

<b>Item #</b>	<b>Description</b>	<b>Copeland Part #</b>
1	Discharge Valve and Solder Bushing Gasket	020-0983-07
2	Joint Ring Gasket for Discharge Valve	020-0006-62
3	3-1/8" Discharge Valve Solder Bushing	036-0832-02
4	Terminal Box	062-0260-00
5	Terminal Box Cover	005-0929-01
5a	Terminal Box Cover Screw	100-0333-00
6	Terminal Plate Assembly	503-0885-00
7	Terminal Plate Gasket	020-1094-00
8	4-1/8" Suction Valve Solder Bushing	036-0832-03
9	Joint Ring Gasket for Suction Valve	020-1044-00
10	Suction Valve and Solder Bushing Gasket	020-1044-00
11	Liquid Injection Fitting M28 x 1-1/4-12 UNF (2 Bolt Flange)	536-0103-00
11a	New Style Liquid Injection Nozzle 2 Bolt Flange x 3/8 Roto Lock	036-0724-25
12	2 Bolt Flange Gasket for Liquid Injection Fitting (Fiber)	020-0012-16
12	2 Bolt FLange Gasket for Eco and Liquid Injection Fitting (Metal)	020-1169-00
13	Eco Fitting Adapter (2 Bolt Flange) 1 3/4-12 UNF	036-0827-00
13a	New Style Eco Fitting/Eco Pulsation Muffler 2 Bolt Flange internal	019-0083-00
14	2 Bolt Flange Gasket for Eco Fitting (Fiber)	020-0012-16
14	2 Bolt FLange Gasket for Eco and Liquid Injection Fitting (Metal)	020-1169-00
15	Teflon O-Ring Liquid Injection Fitting 1 1/14"	020-0028-02
15a	Teflon O-Ring for Eco Injection Fitting 1 3/4"	020-0006-65
16	External Oil Cooling Adapter Plate	034-0115-00
17	Gasket for External Oil Cooling Adapter Plate	020-1069-00
18	4-1/8" Suction Valve	510-0485-00
18a	4-1/8" Suction Valve Kit (includes Valve,Gaskets,Bolts)	510-0428-13
19	Unloader Base Plate Gasket	020-1066-00
20	Check Valve Kit	510-0502-00
21	3-1/8" Discharge Valve	510-0428-04
21a	3-1/8" Discharge Valve Kit (includes Valve,Gaskets,Bolts)	510-0428-11
22	Unloader Flange	510-0428-12
23	24 Volt AC Unloader Solenoid Coil - 5/8"	023-0008-03
23	115 Volt Unloader Solenoid Coil - 5/8"	023-0008-00
23	230 Volt Unloader Solenoid Coil - 5/8"	023-0008-01
24	Unloader Flange Gasket	020-0983-22
25	Oil Sightglass Gasket	020-1068-00
26	300 Watt Crankcase Heater 115 Volt	018-0055-02
26	300 Watt Crankcase Heater 230 Volt	018-0055-03
27	Vibration Damper Kit	527-0184-00
28	Oil / Discharge Temp Sensor	085-0164-00
29	Oil Drain / Fill Valve	010-0049-07
30	Oil Level Control	039-0008-00
31	Stator Cover Gasket	020-1095-00
32	INT69VSY-II 115 Volt Module (Thru Date Code "04E")	071-0549-01
32	INT69VSY-II 230 Volt Module (Thru Date Code "04E")	071-0549-00
32	INT69VSY-II 24 Volt AC Module (Thru Date Code "04E")	071-0549-04
32	SE-S1 115/220 Volt Protection Module (After Date Code "04E")	071-0549-07
32	SE-S1 24 Volt AC Protection Module (After Date Code "04E")	071-0549-08
32	SE-S1 24 Vold DC Protection Module (After Date Code "04E")	071-0549-09
33	Step Down Resistor For INT69VSY-II 575 Volt Appl.	071-0549-05
34	Jumper Bar (3) for DOL Starting	003-0877-03
35	Terminal Box Cover Gasket	020-1073-00
36	12 Position Connector Strip	021-0229-00
37	External Oil Level Control Gasket	020-0006-53
38	M22 Aluminum Washer for Drain Valve	102-0147-00
38a	Teflon O-Ring 3/4" for Oil Drain Valve Fitting	020-0028-01
Not Shown	Compressor Gasket Set	520-0138-00
Not Shown	M63 x 2 1/2" Terminal Box Adapter (QTY 2)	021-0236-00
Not Shown	M25 x 3/4" Terminal Box Adapter (QTY 2)	021-0236-01
Not Shown	M20 x 1/2" Terminal Box Adapter (QTY 2)	021-0236-02
Not Shown	M16 x 1/2" Terminal Box Adapter (QTY 1)	021-0236-03

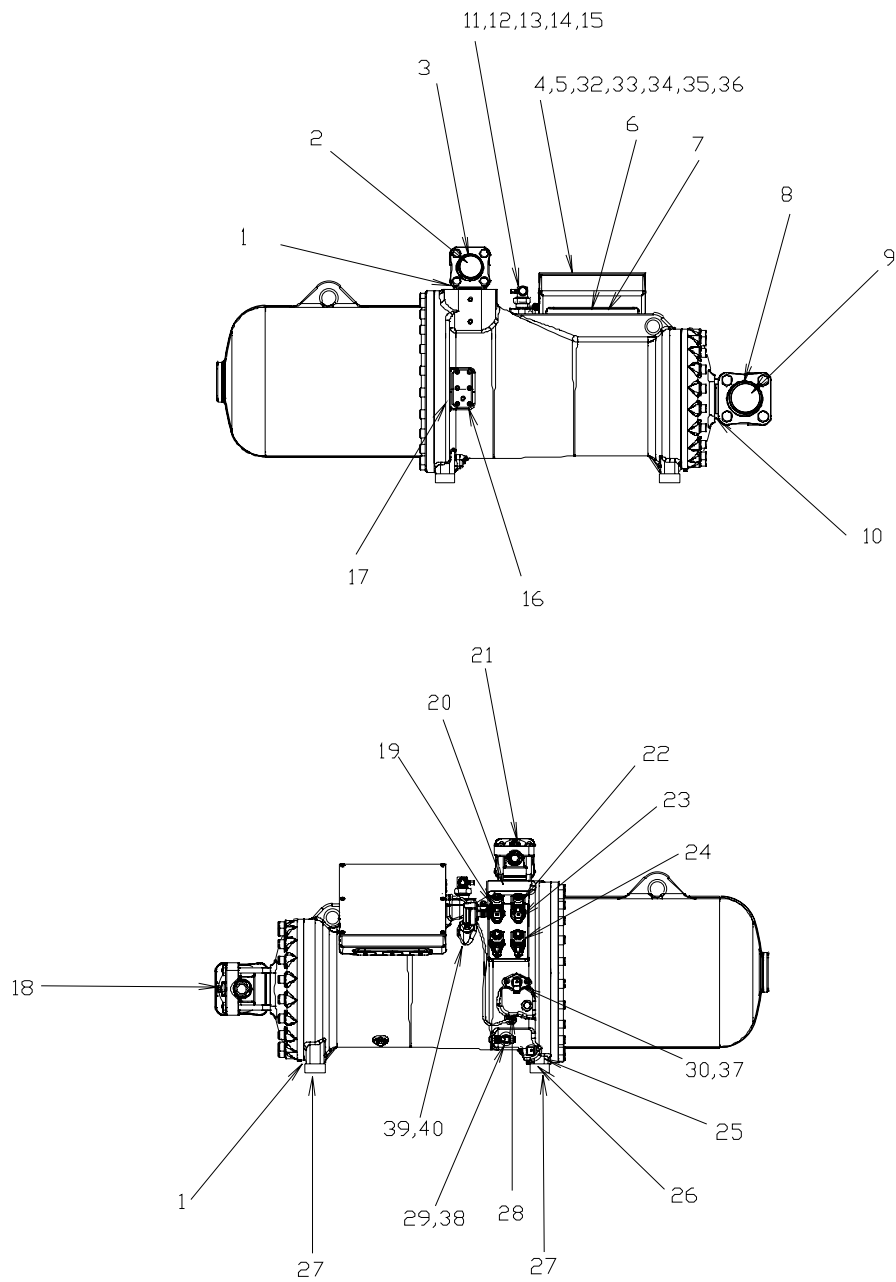
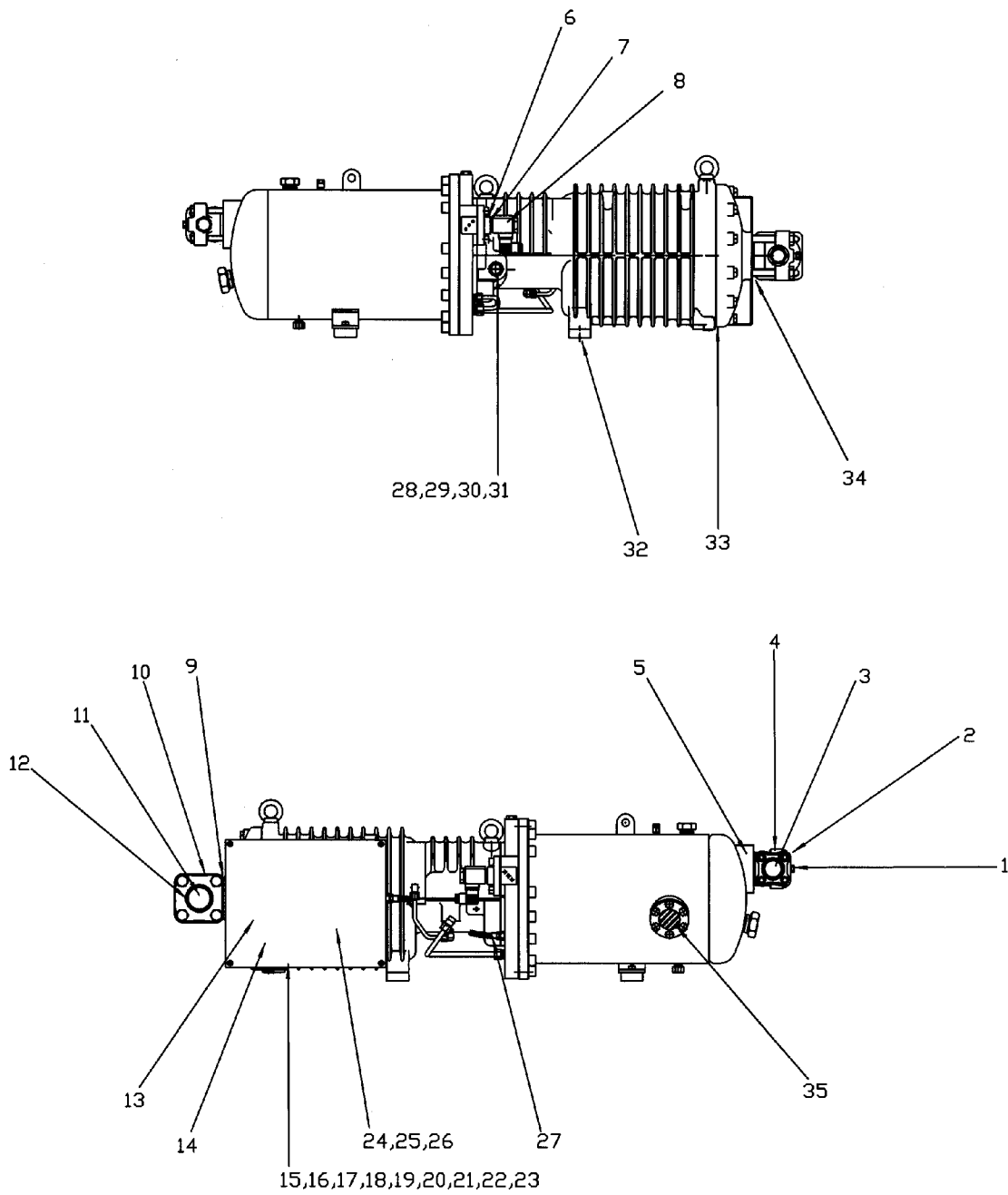

**Figure 4**  
 SCA2 Series Compressor  
 SCA2 Series Compressor

**SCH2-18H0 SCA2-16HE SCA2-24HE**  
**SCH2-21H0 SCA2-18HE**  
**SCH2-24H0 SCA2-21HE**

**See Figure 4**

<b>Item #</b>	<b>Description</b>	<b>Copeland Part #</b>
1	Discharge Valve and Solder Bushing Gasket	020-0983-07
2	Joint Ring Gasket for Discharge Valve	020-0006-62
3	3 1/8" Discharge Valve Solder Bushing	036-0832-02
4	Terminal Box	062-0260-00
5	Terminal Box Cover	005-0929-01
5a	Terminal Box Cover Screw	100-0333-00
6	Terminal Plate Assembly	503-0885-00
7	Terminal Plate Gasket	020-1094-00
8	4 1/8" Suction Valve Solder Bushing (SCH2-18H0,21H0,24H0)	036-0832-03
9	Joint Ring Gasket for Suction Valve (SCH2-18H0,21H0,24H0)	020-1044-00
10	Suction Valve and Solder Bushing Gasket (SCH2-18H0,21H0,24H0)	020-1044-00
11	Liquid Injection Fitting M28 x 1 1/4" - 12 UNF (2 Bolt Flange)	536-0103-00
11a	New Style Liquid Injection Nozzle (2 Bolt Flange x 3/8" Rotolock)	036-0724-25
12	2 Bolt Flange Gasket for Liquid Injection Fitting (Fiber)	020-0012-16
12a	2 Bolt Flange Gasket for ECO and Liquid Injection Fitting (Metal)	020-1169-00
13	ECO Fitting Adapter (2 Bolt Flange x 1 3/4" - 12 UNF)	036-0827-00
13a	New Style ECO Fitting / Pulsation Muffler 2 Bolt Flange	019-0083-00
14	2 Bolt Flange Gasket for ECO Fitting (Fiber)	020-0012-16
14a	2 Bolt Flange Gasket for ECO and Liquid Injection Fitting (Metal)	020-1169-00
15	Teflon O-Ring for Liquid Injection Fitting 1 1/4"	020-0028-02
15a	Teflon O-Ring for ECO Fitting 1 3/4"	020-0006-65
16	External Oil Cooling Adapter Plate	034-0115-00
17	Gasket for External Oil Cooling Adapter Plate	020-1069-00
18	4 1/8" Suction Valve (SCH2-18H0,21H0,24H0)	510-0485-00
18a	4 1/8" Suction Valve Kit (Includes Valve, Gaskets, Bolts)	510-0428-13
18b	5" Suction Valve (SCA2-16HE,18HE,21HE,24HE)	TBD
19	Unloaded Base Plate Gasket	020-1066-00
20	Check Valve Kit	510-0502-00
21	3 1/8" Discharge Valve (SCH2-18H0,21H0,24H0)	510-0428-04
21a	3 1/8" Discharge Valve Kit (Includes Valve, Gaskets, Bolts)	510-0428-11
21b	4 1/8" Discharge Valve (SCA2-16HE,18HE,21HE,24HE)	510-0485-00
22	Unloader Flange	510-0428-12
23	24 Volt AC Unloader Solenoid Coil - 5/8"	023-0008-03
23a	115 Volt AC Unloader Solenoid Coil - 5/8"	023-0008-00
23b	230 Volt AC Unloader Solenoid Coil - 5/8"	023-0008-01
24	Unloader Flange Gasket	020-0983-22
25	Sightglass Gasket	020-1068-00
26	300 Watt Crankcase Heater 115 Volt	018-0055-02
26a	300 Watt Crankcase Heater 230 Volt	018-0055-03
27	Vibration Damper Kit	TBD
28	Oil / Discharge Temperature Sensor	085-0164-00
29	Oil Drain / Fill Valve	010-0049-07
30	Oil Level Control	039-0008-00
31	Stator Cover Gasket	TBD
32	INT 69VSY-II 115 Volt Module (Thru Date Code "04E")	071-0549-01
32a	INT 69VSY-II 230 Volt Module (Thru Date Code "04E")	071-0549-00
32b	INT 69VSY-II 24 Volt AC Module (Thru Date Code "04E")	071-0549-04
32c	SE-E1 115/220 Volt Protection Module (After Date Code "04E")	071-0549-07
32d	SE-E1 24 Volt AC Protection Module (After Date Code "04E")	071-0549-08
32e	SE-E1 24 Volt DC Protection Module (After Date Code "04E")	071-0549-09
33	Step Down Resistor for INT69VSY-II 575 Volt Applications	071-0549-05
34	Jumper Bar (3) for DOL Starting	003-0877-03
35	Terminal Box Cover Gasket	020-1073-00
36	12 Position Connector Strip	021-0229-00
37	External Oil Level Control Gasket	020-0006-53
38	M22 Aluminum Washer for Drain Valve	102-0147-00
38a	Teflon O-Ring 3/4" for Oil Drain Valve Fitting	020-0028-01
39	Slide Valve Position Transmitter	TBD
40	Slide Valve Position Transmitter 2 Bolt Gasket	TBD
Not Shown	Complete Gasket Set	TBD
Not Shown	M63 x 2 1/2" Terminal Box Adapter	021-0236-00
Not Shown	M25 x 3/4" Terminal Box Adapter	021-0236-01
Not Shown	M20 x 1/2" Terminal Box Adapter	021-0236-02
Not Shown	M16 x 1/2" Terminal Box Adapter	021-0236-03

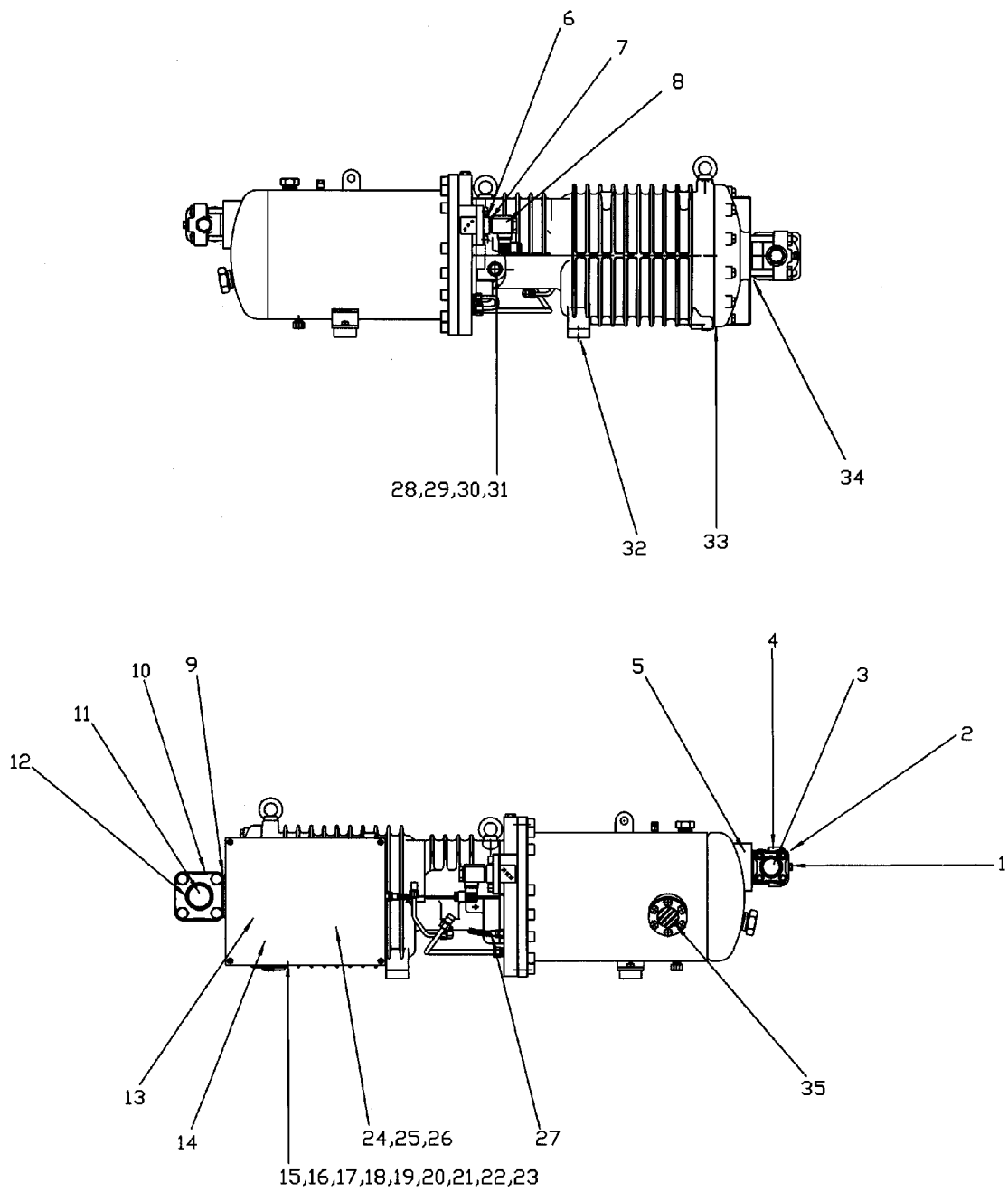

**Figure 5**  
SCH1 Series Compressors

**SCH1-7000**  
**SCH1-8000**  
**SCH1-9000**

**See Figure 5**

<b>Item #</b>	<b>Description</b>	<b>Copeland Part #</b>
1	2-1/8" Discharge Valve	510-0428-03
1a	2-1/8" Discharge Valve Kit (includes Valve,Gaskets,Bolts)	510-0428-14
2	Discharge Valve and Solder Bushing Gasket	020-0983-06
3	2-1/8" Discharge Valve Solder Bushing	036-0832-00
4	Joint Ring Gasket for Discharge Valve	020-0983-09
5	Check Valve Kit	510-0428-10
6	Unloader Flange Gasket	020-0983-14
7	Unloader Flange	510-0428-01
8	24 Volt AC Unloader Solenoid Coil - 5/8"	023-0008-03
8	115 Volt Unloader Solenoid Coil - 5/8"	023-0008-00
8	230 Volt Unloader Solenoid Coil - 5/8"	023-0008-01
9	Joint Ring Gasket for Suction Valve	020-0983-07
10	3-1/8" Suction Valve	510-0428-04
10a	3-1/8" Suction Valve Kit (includes Valve,Gaskets,Bolts)	510-0428-11
11	3-1/8" Suction Valve Solder Bushing	036-0832-02
12	Suction Valve and Solder Bushing Gasket	020-0006-62
13	Terminal Plate Assembly	560-0004-00
14	Terminal Plate Gasket	020-0983-11
15	Terminal Box	062-0240-01
16	Terminal Box Cover	005-0929-01
17	INT69VSY-II 115 Volt Module	071-0549-01
17	INT69VSY-II 230 Volt Module	071-0549-00
17	INT69VSY-II 24 Volt AC Module	071-0549-04
17	SE-S1 115/220 Volt Protection Module	071-0549-07
17	SE-S1 24 Volt AC Protection Module	071-0549-08
17	SE-S1 24 Volt DC Protection Module	071-0549-09
18	Jumper Bar (3) for DOL Starting	003-0877-02
19	Step Down Resistor For INT69VSY-II 575 Volt Appl.	071-0549-05
20	Terminal Box Cover Gasket	020-0983-19
21	12 Position Connector Strip	021-0229-00
22	Terminal Box Cover Screw M6 x 12	100-0037-00
23	Terminal Box Screw M6 x 12	100-0037-00
24	Plug - TL4	005-1024-00
25	Plug - K18	005-1025-00
26	Plug - PG48	005-1026-00
27	Oil / Discharge Temp Sensor	085-0164-00
28	Eco Fitting M26 x 1-1/4-12 UNF Kit	536-0724-10
29	M26 Aluminum Washer for Eco Fitting	102-0147-01
30	Eco Fitting M26 x 5/8 Flare Kit	536-0724-13
31	Teflon O-Ring for Eco Fitting	020-0028-02
32	Vibration Damper Kit	019-0075-01
33	Stator Cover Gasket	020-1063-00
34	Suction Screen	013-0117-00
35	Sightglass Kit	560-0004-02
Not Shown	Compressor Gasket Set	560-0004-16

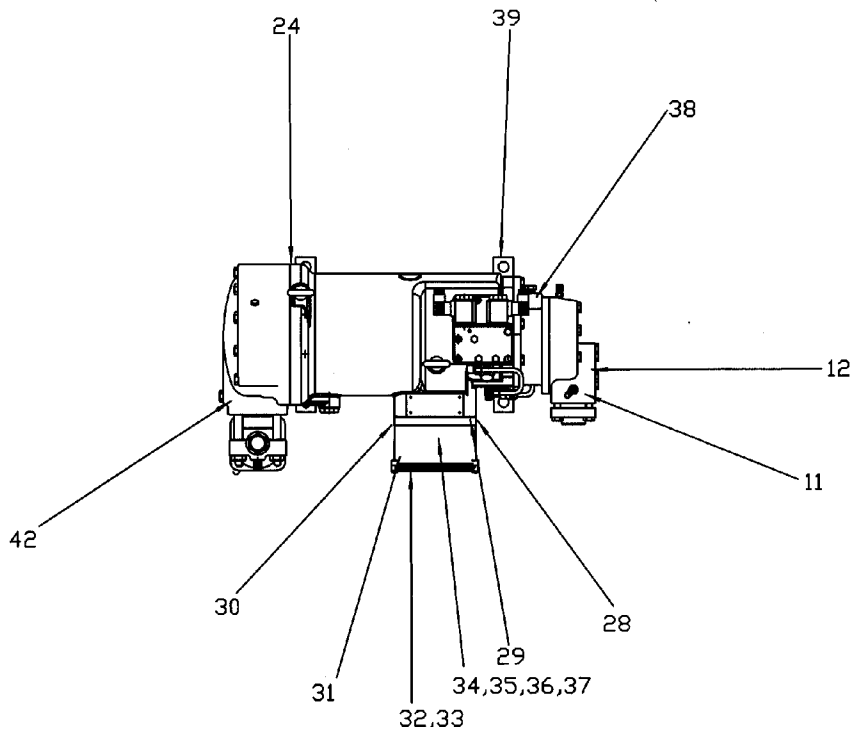
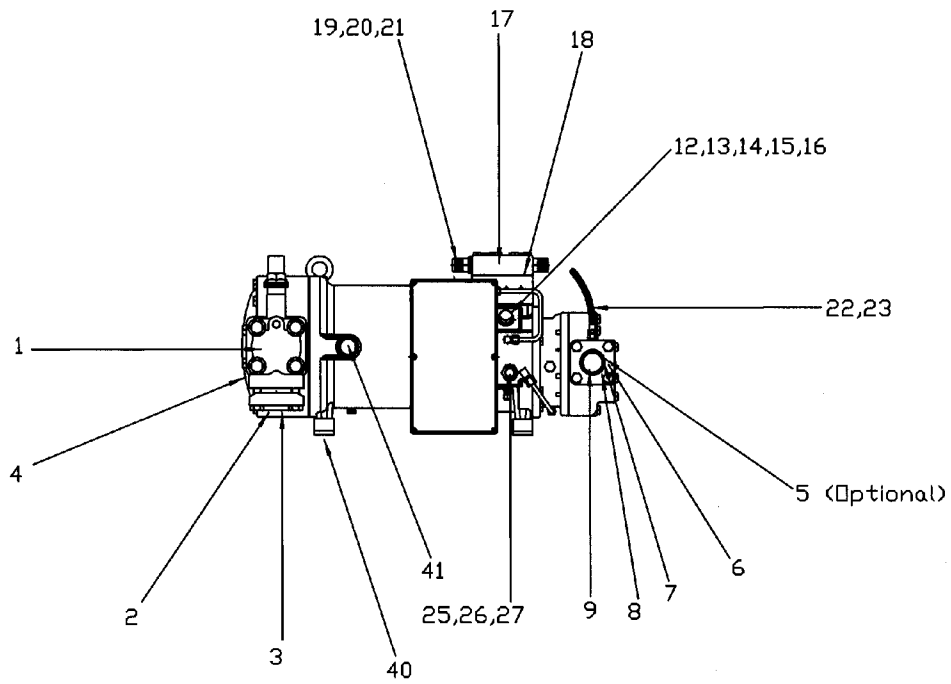

**Figure 6**  
SCH1 Series Compressors

**SCH1-5000  
SCH1-6000**

**See Figure 6**

<b>Item #</b>	<b>Description</b>	<b>Copeland Part #</b>
1	1-5/8" Discharge Valve	510-0428-02
1a	1-5/8" Discharge Valve Kit (includes Valve,Gaskets,Bolts)	510-0428-15
2	Discharge Valve and Solder Bushing Gasket	020-0983-08
3	1-5/8" Discharge Valve Solder Bushing	036-0724-18
4	Joint Ring Gasket for Discharge Valve	020-0983-08
5	Check Valve Kit	510-0428-09
6	Unloader Flange Gasket	020-0983-14
7	Unloader Flange	510-0428-12
8	24 Volt AC Unloader Solenoid Coil - 5/8"	023-0008-03
8	115 Volt Unloader Solenoid Coil - 5/8"	023-0008-00
8	230 Volt Unloader Solenoid Coil - 5/8"	023-0008-01
9	Joint Ring Gasket for Suction Valve	020-0983-06
10	2-1/8" Suction Valve	510-0428-03
10a	2-1/8" Suction Valve Kit (includes Valve,Gaskets,Bolts)	510-0428-03
11	2-1/8" Suction Valve Solder Bushing	036-0832-00
12	Suction Valve and Solder Bushing Gasket	020-0983-06
13	Terminal Plate Assembly	560-0004-00
14	Terminal Plate Gasket	020-0983-11
15	Terminal Box	062-0240-01
16	Terminal Box Cover	005-0929-01
17	INT69VSY-II 115 Volt Module	071-0549-01
17	INT69VSY-II 230 Volt Module	071-0549-00
17	INT69VSY-II 24 Volt AC Module	071-0549-04
17	SE-S1 115/220 Volt Protection Module	071-0549-07
17	SE-S1 24 Volt AC Protection Module	071-0549-08
17	SE-S1 24 Volt DC Protection Module	071-0549-09
18	Jumper Bar (3) for DOL Starting	003-0877-02
19	Step Down Resistor For INT69VSY-II 575 Volt Appl.	071-0549-05
20	Terminal Box Cover Gasket	020-0983-19
21	12 Position Connector Strip	021-0229-00
22	Terminal Box Cover Screw M6 x 12	100-0037-00
23	Terminal Box Screw M6 x 12	100-0037-00
24	Plug - TL4	005-1024-00
25	Plug - K18	005-1025-00
26	Plug - PG48	005-1026-00
27	Oil / Discharge Temp Sensor	085-0164-00
28	Eco Fitting M26 x 1-1/4-12 UNF Kit	536-0724-10
29	M26 Aluminum Washer for Eco Fitting	102-0147-01
30	Eco Fitting M26 x 5/8 Flare Kit	536-0724-13
31	Teflon O-Ring for Eco Fitting	020-0028-02
32	Vibration Damper Kit	019-0075-00
33	Stator Cover Gasket	020-1063-00
34	Suction Screen	013-0117-01
35	Sightglass Kit	560-0004-02
Not Shown	Compressor Gasket Set	560-0004-03



**Figure 7**  
 SHL2-2000, 2500, 3000  
 SHM2-3000, 3500, 4000

**SHL2-2000**  
**SHL2-2500**  
**SHL2-3000**

**SHM2-3000**  
**SHM2-3500**  
**SHM2-4000**

**See Figure 7**

<b>Item #</b>	<b>Description</b>	<b>Copeland Part #</b>
1	2-1/8" Suction Service Valve	510-0428-03
1a	2-1/8" Suction Valve Kit (includes Valve,Gaskets,Bolts)	510-0428-14
2	2-1/8" Solder Bushing	036-0832-00
3	Joint Ring Gasket for 2-1/8" Solder Bushing	020-0983-09
4	2-1/8" Suction Valve Gasket	020-0983-06
5	1-5/8" Discharge Service Valve - Optional	510-0428-02
5a	1-5/8" Discharge Valve Kit (includes Valve,Gaskets,Bolts)	510-0428-15
6	1-5/8" Solder Bushing - Valve	036-0724-18
7	1-5/8" Solder Bushing Connection	036-0832-01
8	Joint Ring Gasket for 1-5/8" Solder Bushing	020-0983-08
9	Discharge Valve and Pipe Connection Gasket	020-0983-08
10	1-5/8" Discharge Check Valve Kit	510-0428-06
11	Flange Gasket	020-0983-15
12	M26 x 1-1/4 - 12 UNF Eco Fitting Kit	536-0724-10
13	M26 x 1-1/4 - 12 UNF Eco Fitting	036-0724-10
14	M26 Aluminum Washer for Eco Fitting	102-0147-01
15	Teflon O-Ring for Eco Fitting	020-0028-02
16	M26 x 5/8" Flare Eco Fitting Kit	536-0724-13
17	2 Step Unloader Flange	003-0975-00
18	Top 2 Step Unloader Flange Gasket	020-1081-00
19	24 Volt Unloader Solenoid Coil - 5/8"	023-0008-03
20	115 Volt Unloader Solenoid Coil - 5/8"	023-0008-00
21	230 Volt Unloader Solenoid Coil - 5/8"	023-0008-01
22	PTC 100 Discharge Temp Sensor (Red)	085-0164-01
23	PT1000 Discharge Temp Sensor (White)	085-0167-00
24	Stator Cover Gasket	020-0983-10
25	M22 Oil Connection Fitting Aluminum Washer	102-0147-00
26	Oil Solder Stub Connection	036-0724-21
27	1" - 14 UNS Flare Nut for Oil Stub Connection	101-0010-24
28	Terminal Plate Gasket	020-1062-00
29	Terminal Plate Assembly	560-0004-01
30	Terminal Box Gasket	020-0983-02
31	Terminal Box	062-0240-00
32	Terminal Box Cover	005-0929-00
33	Terminal Box Cover Gasket	020-0983-04
34	16 Strip Connector Block	021-0029-01
35	M16 x 12 Terminal Box Cover Screw	100-0337-00
36	M4 Terminal Plate Sensor Lead Nut	101-0115-00
37	M8 Terminal Plate Lead Nut	101-0116-00
38	Bearing Cover Gasket	020-0983-15
39	Compressor Mounting Foot	074-0892-00
40	Vibration Mounting Kit (Incls bolts-washers-nuts & pads)	019-0075-02
41	Stator Mounting Bolt O-Ring	100-0302-00
42	Suction Screen	013-0117-02
Not Shown	Vibration Damper Set (Pads Only)	560-0005-00
Not Shown	1-1/4" x 7/8" Roto-Lock Valve for Eco Fitting	510-0428-05
Not Shown	Compressor Gasket Set	560-0004-06
Not Shown	2 Step Lower Control Body Flange Gasket	020-1099-00

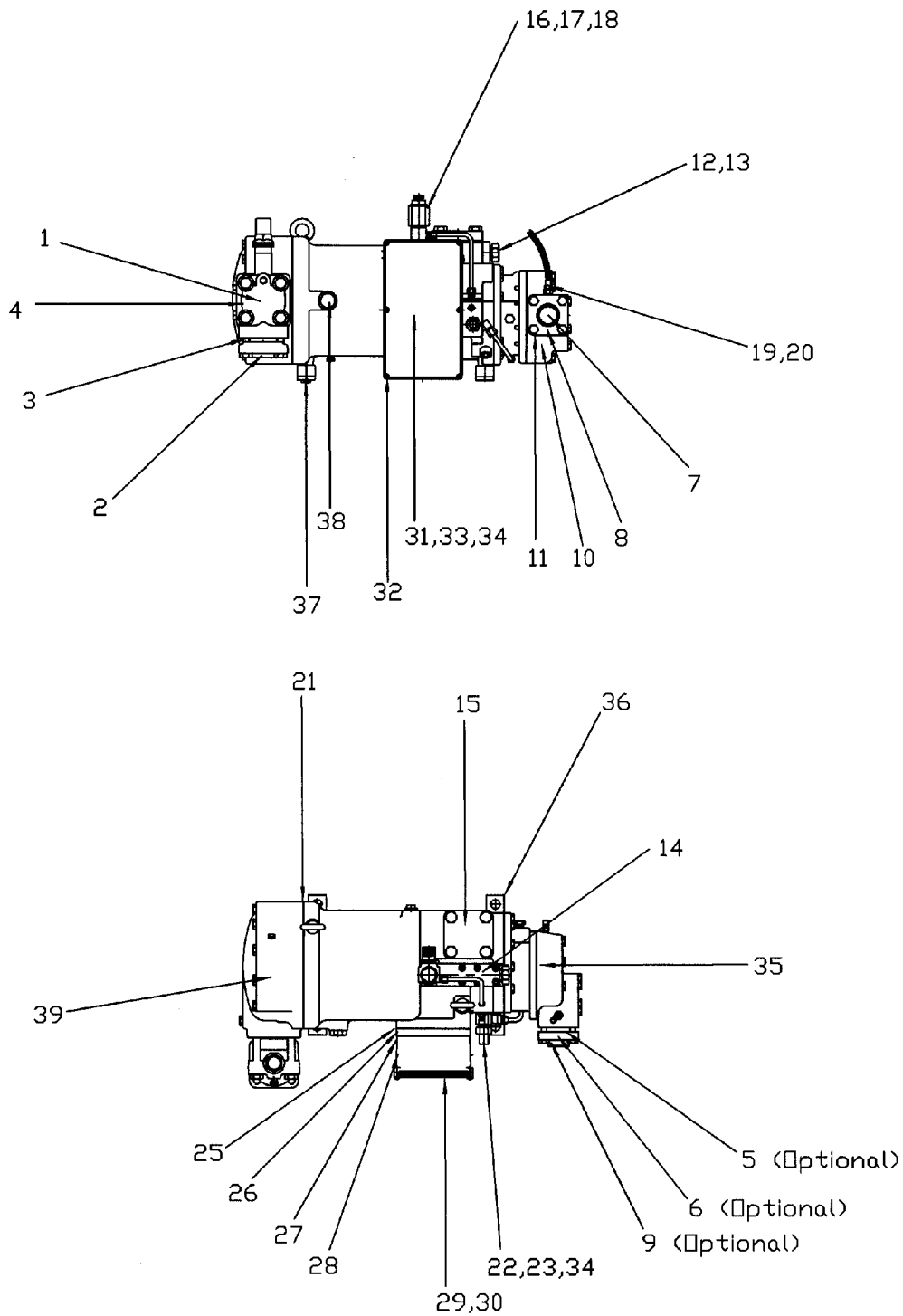
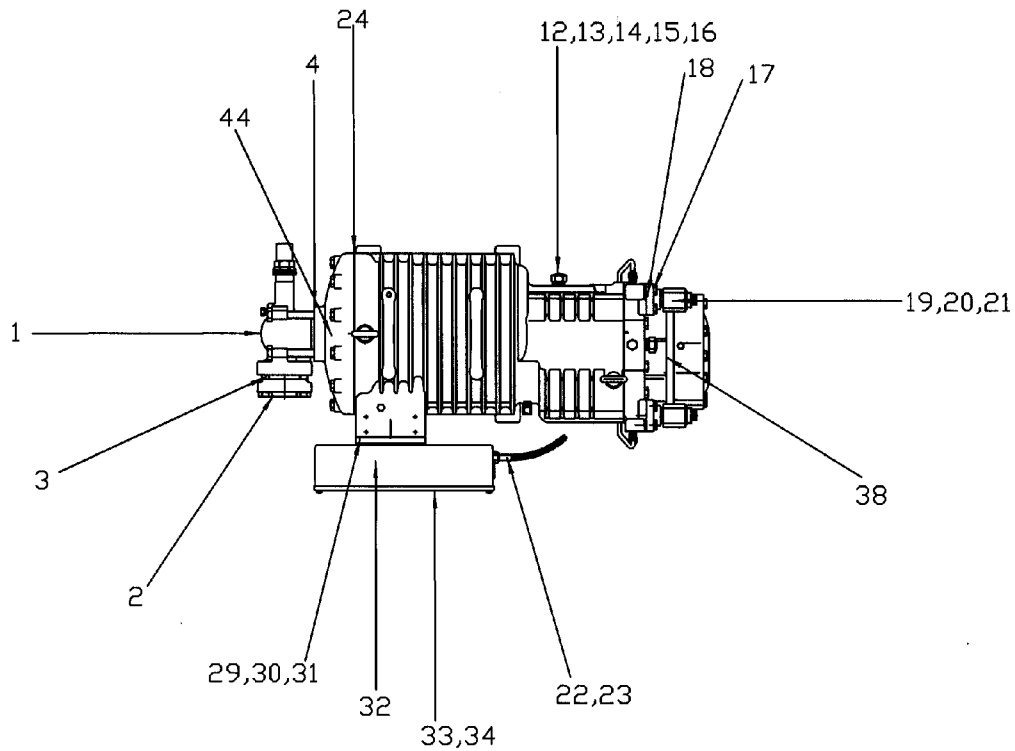
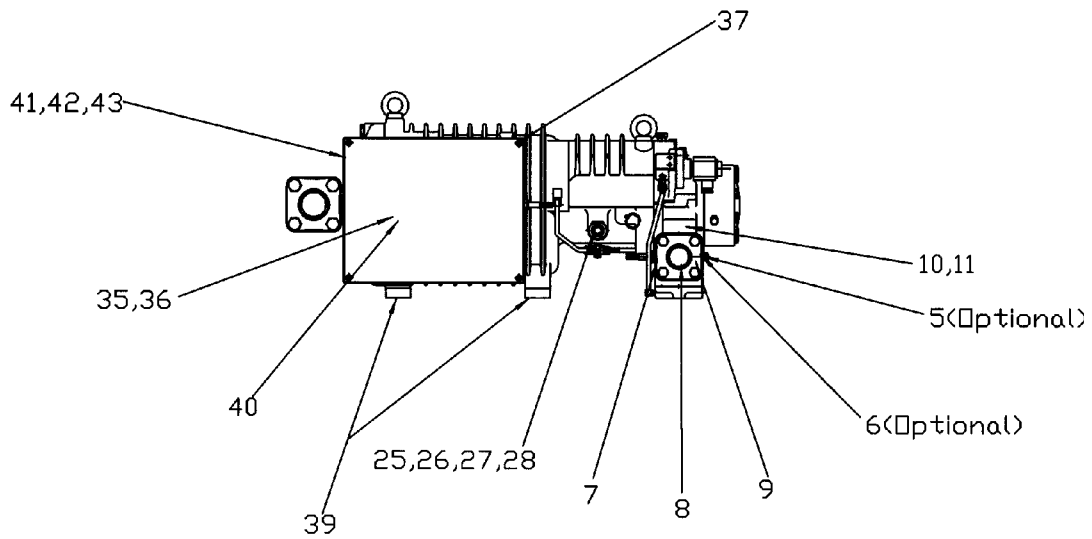

**Figure 8**  
 SHL1-2000, 2500, 3000  
 SHM1-3000, 3500, 4000

**SHL1-2000    SHM1-3000**  
**SHL1-2500    SHM1-3500**  
**SHL1-3000    SHM1-4000**

**See Figure 8**

<b>Item #</b>	<b>Description</b>	<b>Copeland Part #</b>
1	2-1/8" Suction Service Valve	510-0428-03
1a	2-1/8" Suction Valve Kit (includes Valve,Gaskets,Bolts)	510-0428-14
2	2-1/8" Solder Bushing	036-0832-00
3	Joint Ring Gasket for 2-1/8" Solder Bushing	020-0983-09
4	2-1/8" Suction Valve Gasket	020-0983-06
5	1-5/8" Discharge Service Valve - Optional	510-0428-02
5a	1-5/8" Discharge Valve Kit (includes Valve,Gaskets,Bolts)	510-0428-15
6	1-5/8" Solder Bushing - Valve	036-0724-18
7	1-5/8" Solder Bushing Connection	036-0832-01
8	Joint Ring Gasket for 1-5/8" Solder Bushing	020-0983-08
9	Discharge Valve and Pipe Connection Gasket	020-0983-08
10	1-5/8" Discharge Check Valve Kit	510-0428-06
11	Flange Gasket	020-0983-15
12	Liquid Injection Solder Stub	036-0724-22
13	Flare Nut for Liquid Injection Solder Stub 1-1/4"-12 UNF	101-0010-25
14	Unloader Flange	510-0428-00
15	Joint Ring Gasket for Shipping Flange 2-1/8"	020-0983-06
16	24 Volt Unloader Solenoid Coil - 5/8"	023-0008-03
17	115 Volt Unloader Solenoid Coil - 5/8"	023-0008-00
18	230 Volt Unloader Solenoid Coil - 5/8"	023-0008-01
19	PTC 100 Discharge Temp Sensor (Red)	085-0164-01
20	PT1000 Discharge Temp Sensor (White)	085-0167-00
21	Stator Cover Gasket	020-0983-10
22	M22 Oil Connection Fitting Aluminum Washer	102-0147-00
23	Oil Solder Stub Connection	036-0724-21
24	1" - 14 UNS Flare Nut for Oil Stub Connection	101-0010-24
25	Terminal Plate Gasket	020-1062-00
26	Terminal Plate Assembly	560-0004-01
27	Terminal Box Gasket	020-0983-02
28	Terminal Box	062-0240-00
29	Terminal Box Cover	005-0929-00
30	Terminal Box Cover Gasket	020-0983-04
31	16 Strip Connector Block	021-0029-01
32	M16 x 12 Terminal Box Cover Screw	100-0337-00
33	M4 Terminal Plate Sensor Lead Nut	101-0115-00
34	M8 Terminal Plate Lead Nut	101-0116-00
35	Bearing Cover Gasket	020-0983-15
36	Compressor Mounting Foot	074-0892-00
37	Vibration Mounting Kit (Incls bolts-washers-nuts & pads)	019-0075-02
38	Stator Mounting Bolt O-Ring	100-0302-00
39	Suction Screen	013-0117-02
Not Shown	Vibration Damper Set (Pads Only)	560-0005-00
Not Shown	1-1/4" x 7/8" Roto-Lock Valve for Eco Fitting	510-0428-05
Not Shown	Compressor Gasket Set	560-0004-06



**Figure 9**  
 SHL1-4000, 5000  
 SHM1-5000, 6000

**SHL1-4000**  
**SHL1-5000**

**SHM1-5000**  
**SHM1-6000**

**See Figure 9**

Item #	Description	Copeland Part #
1	2-1/8" Suction Service Valve	510-0428-03
1a	2-1/8" Suction Valve Kit (includes Valve,Gaskets,Bolts)	510-0428-14
2	2-1/8" Solder Bushing	036-0832-00
3	Joint Ring Gasket for 2-1/8" Solder Bushing	020-0983-09
4	2-1/8" Suction Valve Gasket	020-0983-06
5	1-5/8" Discharge Service Valve - Optional	510-0428-02
5a	1-5/8" Discharge Valve Kit (includes Valve,Gaskets,Bolts)	510-0428-15
6	1-5/8" Solder Bushing - Valve	036-0724-18
7	1-5/8" Solder Bushing Connection	036-0832-01
8	Joint Ring Gasket for 1-5/8" Solder Bushing	020-0983-05
9	Discharge Valve and Pipe Connection Gasket	020-0983-05
10	1-5/8" Discharge Check Valve Kit	510-0428-07
11	Flange Gasket	020-0983-12
12	M26 x 1-1/4 - 12 UNF Eco Fitting Kit	536-0724-10
13	M26 x 1-1/4 - 12 UNF Eco Fitting	036-0724-10
14	M26 Aluminum Washer for Eco Fitting	102-0147-01
15	Teflon O-Ring for Eco Fitting	020-0028-02
16	M26 x 5/8" Flare Eco Fitting Kit	536-0724-13
17	Unloader Flange	510-0428-01
18	Unloader Flange Gasket	020-0983-14
19	24 Volt Unloader Solenoid Coil - 5/8"	023-0008-03
20	115 Volt Unloader Solenoid Coil - 5/8"	023-0008-00
21	230 Volt Unloader Solenoid Coil - 5/8"	023-0008-01
22	PTC 100 Discharge Temp Sensor (Red)	085-0164-01
23	PT1000 Discharge Temp Sensor (White)	085-0167-00
24	Stator Cover Gasket	020-1063-00
25	M22 Oil Connection Fitting Aluminum Washer	102-0147-00
26	Oil Solder Stub Connection	036-0724-22
27	1-1/4" - 12 UNF Flare Nut for Oil Stub Connection	101-0010-25
28	M22 x 1-1/4" - 12 UNF Screwed Socket / Oil	036-0724-20
29	Terminal Plate Gasket	020-0983-11
30	Terminal Plate Assembly	560-0004-00
31	Terminal Box Gasket	020-0983-03
32	Terminal Box	062-0240-01
33	Terminal Box Cover	005-0929-01
34	Terminal Box Cover Gasket	020-0983-20
35	16 Strip Connector Block	021-0029-01
36	M10 x 16 Terminal Bolt	100-0302-01
37	M6 x 12 Terminal Box Cover Screw	100-0337-00
38	Discharge Flange Cover Gasket	020-1061-00
39	Vibration Mounting Kit	019-0075-00
40	Jumper Bar Kit for DOL Starting	003-0877-02
41	Plug - TL4 (Terminal Box)	005-1024-00
42	Plug - K18 (Terminal Box)	005-1025-00
43	Plug - PG48 (Terminal Box)	005-1026-00
44	Suction Screen	013-0117-01
Not Shown	1-1/4" x 7/8" Roto-Lock Valve for Eco Fitting	510-0428-05
Not Shown	Compressor Gasket Set	560-0004-04

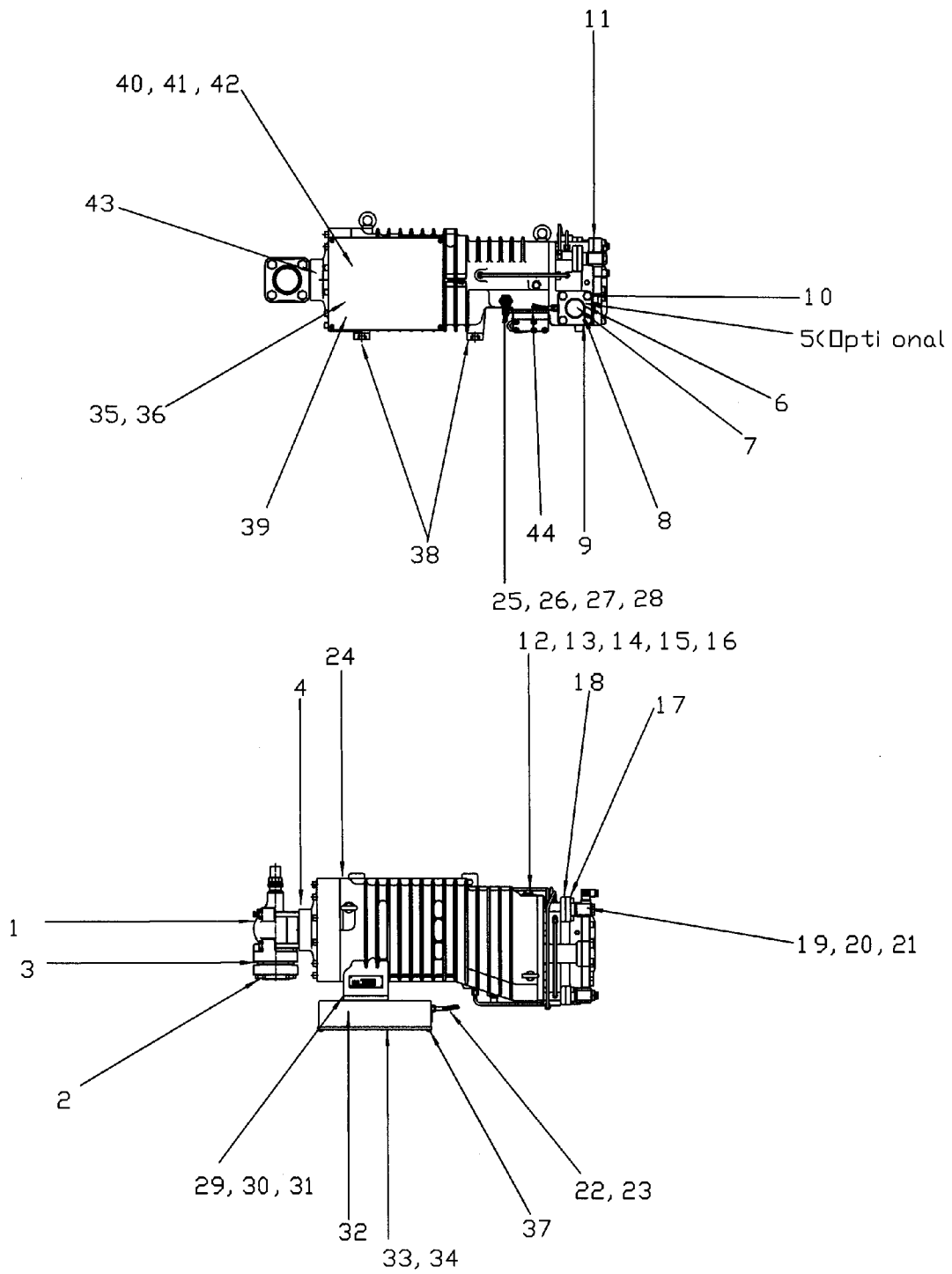
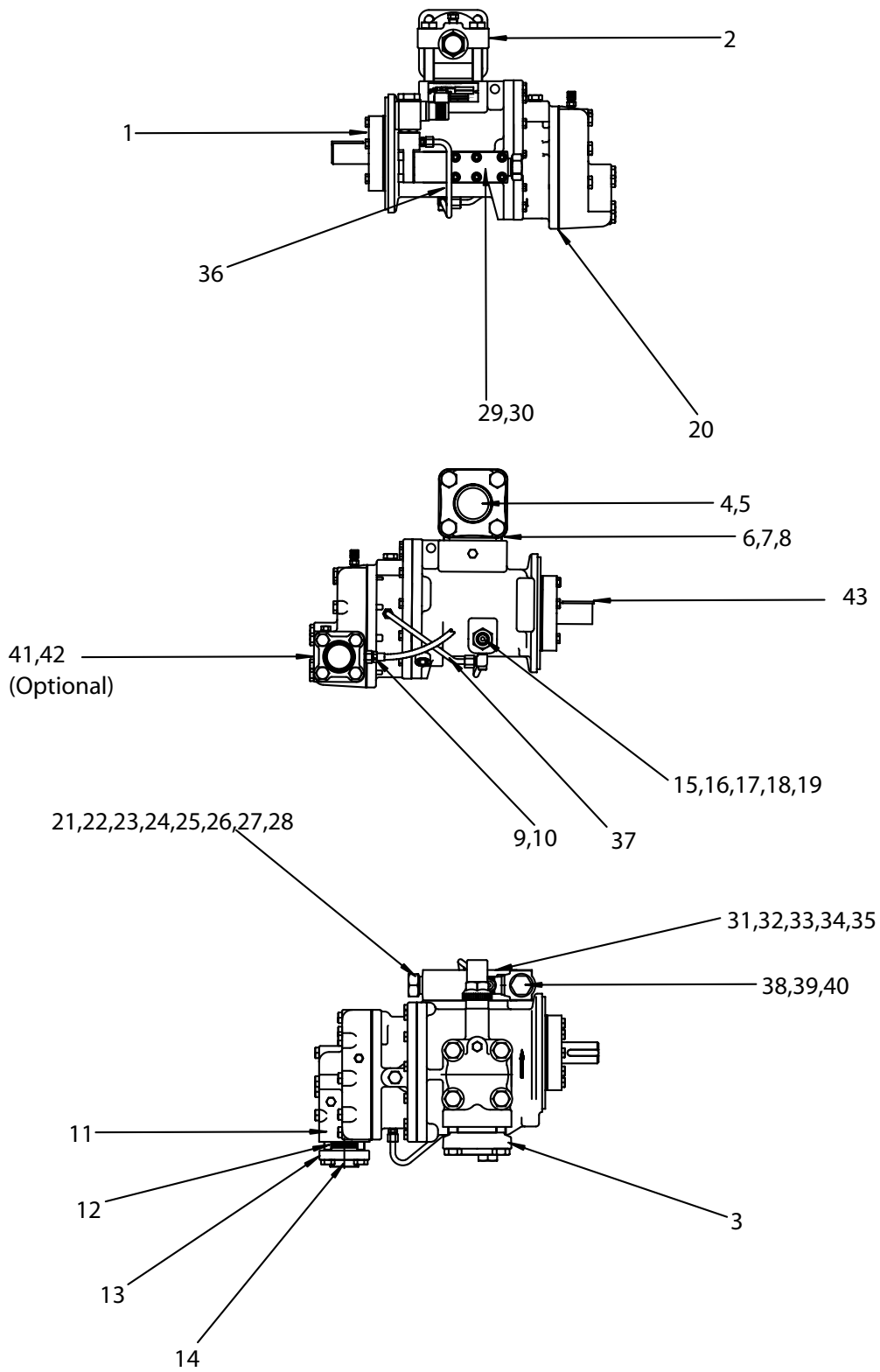

**Figure 10**  
 SHL1-6000, 7000, 7500  
 SHM1-7000, 8000, 9000

**SHL1-6000 SHM1-7000**  
**SHL1-7000 SHM1-8000**  
**SHL1-7500 SHM1-9000**

**See Figure 10**

<b>Item #</b>	<b>Description</b>	<b>Copeland Part #</b>
1	3-1/8" Suction Service Valve	510-0428-04
1a	3-1/8" Suction Valve Kit (includes Valve,Gaskets,Bolts)	510-0428-11
2	3-1/8" Solder Bushing	036-0832-02
3	Joint Ring Gasket for 3-1/8" Solder Bushing	020-0006-62
4	3-1/8" Suction Valve Gasket	020-0006-62
5	2-1/8" Discharge Service Valve - Optional	510-0428-03
5a	2-1/8" Discharge Valve Kit (includes Valve,Gaskets,Bolts)	510-0428-14
6	2-1/8" Solder Bushing - Valve	036-0832-00
7	2-1/8" Solder Bushing Connection	036-0832-00
8	Joint Ring Gasket for 2-1/8" Solder Bushing	020-0983-08
9	Discharge Valve and Pipe Connection Gasket	020-0983-06
10	2-1/8" Discharge Check Valve Kit	510-0428-08
11	Flange Gasket	020-0983-16
12	M26 x 1-1/4 - 12 UNF Eco Fitting Kit	536-0724-10
13	M26 x 1-1/4 - 12 UNF Eco Fitting	036-0724-10
14	M26 Aluminum Washer for Eco Fitting	102-0147-01
15	Teflon O-Ring for Eco Fitting	020-0028-02
16	M26 x 5/8" Flare Eco Fitting Kit	536-0724-13
17	Unloader Flange	510-0428-01
18	Unloader Flange Gasket	020-0983-14
19	24 Volt Unloader Solenoid Coil - 5/8"	023-0008-03
20	115 Volt Unloader Solenoid Coil - 5/8"	023-0008-00
21	230 Volt Unloader Solenoid Coil - 5/8"	023-0008-01
22	PTC 100 Discharge Temp Sensor (Red)	085-0164-01
23	PT1000 Discharge Temp Sensor (White)	085-0167-00
24	Stator Cover Gasket	020-1063-00
25	M22 Oil Connection Fitting Aluminum Washer	102-0147-00
26	Oil Solder Stub Connection	036-0724-22
27	1-1/4" - 12 UNF Flare Nut for Oil Stub Connection	101-0010-25
28	M22 x 1-1/4" - 12 UNF Screwed Socket / Oil	036-0724-20
29	Terminal Plate Gasket	020-0983-11
30	Terminal Plate Assembly	560-0004-00
31	Terminal Box Gasket	020-0983-03
32	Terminal Box	062-0240-01
33	Terminal Box Cover	005-0929-01
34	Terminal Box Cover Gasket	020-0983-20
35	16 Strip Connector Block	021-0029-01
36	M10 x 16 Terminal Bolt	100-0302-01
37	M6 x 12 Terminal Box Cover Screw	100-0337-00
38	Vibration Mounting Kit	019-0075-01
39	Jumper Bar Kit for DOL Starting	003-0877-02
40	Plug - TL4 (Terminal Box)	005-1024-00
41	Plug - K18 (Terminal Box)	005-1025-00
42	Plug - PG48 (Terminal Box)	005-1026-00
43	Suction Screen	013-0117-00
44	Gasket, Control Cover Plate	020-0983-17
Not Shown	1-1/4" x 7/8" Roto-Lock Valve for Eco Fitting	510-0428-05
Not Shown	Compressor Gasket Set	560-0004-05



**Figure 11**  
SDL1/SDM1 Compressors

**SDL1-0084**  
**SDL1-0100**  
**SDL1-0118**

**SDM1-0084**  
**SDM1-0100**  
**SDM1-0118**

**Figure 11**

<b>Item #</b>	<b>Description</b>	<b>Copeland Part #</b>
1	Shaft Seal Complete	560-0004-13
2	2-1/8" Suction Service Valve	510-0428-03
3	2-1/8" Suction Valve Clamping Plate	003-1035-01
4	2-1/8" Solder Bushing	036-0832-00
5	Joint Ring Gasket for 2-1/8" Solder Bushing	020-0983-09
6	2-1/8" Suction Valve Gasket	020-0006-46
7	Suction Screen	013-0142-00
8	Suction Screen Gasket	020-0006-46
9	PT1000 Discharge Temp Sensor (White)	085-0167-00
10	PTC 100 Discharge Temp Sensor (Red)	085-0164-01
11	Discharge Check Valve	510-0428-06
12	Joint Ring Gasket for 1-5/8" Solder Bushing	020-0983-08
13	1-5/8" Discharge Clamping Plate	003-1035-00
14	1-5/8" Discharge Solder Bushing	036-0724-18
15	M22 Oil Connection Fitting Aluminum Washer	102-0147-00
16	M22 x 1-1/4" - 12 UNF Screwed Socket / Oil	036-0724-19
17	Teflon O-Ring for Oil Socket	020-0006-63
18	Oil Solder Stub Connection	036-0724-22
19	1-14 UNS Flare Nut for Oil Stub Connection	101-0010-24
20	Discharge Flange Gasket	020-0983-15
21	M22 Alumimun Washer for ECO Fitting	102-0147-00
22	M22 x 1.5 x UNF 1-1/4" Screwed Socket for ECO	036-0724-20
23	Teflon O-Ring for Screwed Socket for ECO	020-0006-64
24	ECO Solder Fitting	036-0724-22
25	Flare Nut for ECO Solder Connection 1-1/4"-12UNF	101-0010-25
26	ECO Fitting Kit (incl fitting, alum washer & o-ring)	536-0724-12
27	Flare Nut for Unloader Block ECO Conn 1-1/4"-12UNF	101-0010-25
28	ECO Solder Stub Connection for Unloader Block	036-0724-22
29	O-Ring for Unloader Blockand/or Back Plate (Qty=2)	020-1127-00
30	Back Cover Plate	003-1033-00
31	Unloader Block	003-1034-00
32	Unloader Piston Spring	006-0395-00
33	Unloader Piston	004-0431-00
34	Unloader Gasket	020-0983-13
35	Unloader Flange	510-0428-00
36	Oil Line Complete	028-1209-00
37	Oil Line Complete	028-1210-00
38	24 Volt Unloader Solenoid Coil - 5/8"	023-0008-03
39	115 Volt Unloader Solenoid Coil - 5/8"	023-0008-00
40	230 Volt Unloader Solenoid Coil - 5/8"	023-0008-01
41	1-5/8" Discharge Service Valve	510-0428-02
42	1-5/8" Disch Service Valve Kit (includes Valve,Gaskets,Bolts)	510-0428-15
43	Shaft Key	075-0014-01
Not Shown	Vibration Mounting Kit	019-0075-01
Not Shown	1-1/4" x 7/8" Roto-Lock Valve for Eco Fitting	510-0428-05
Not Shown	Compressor Gasket Set	520-0142-00

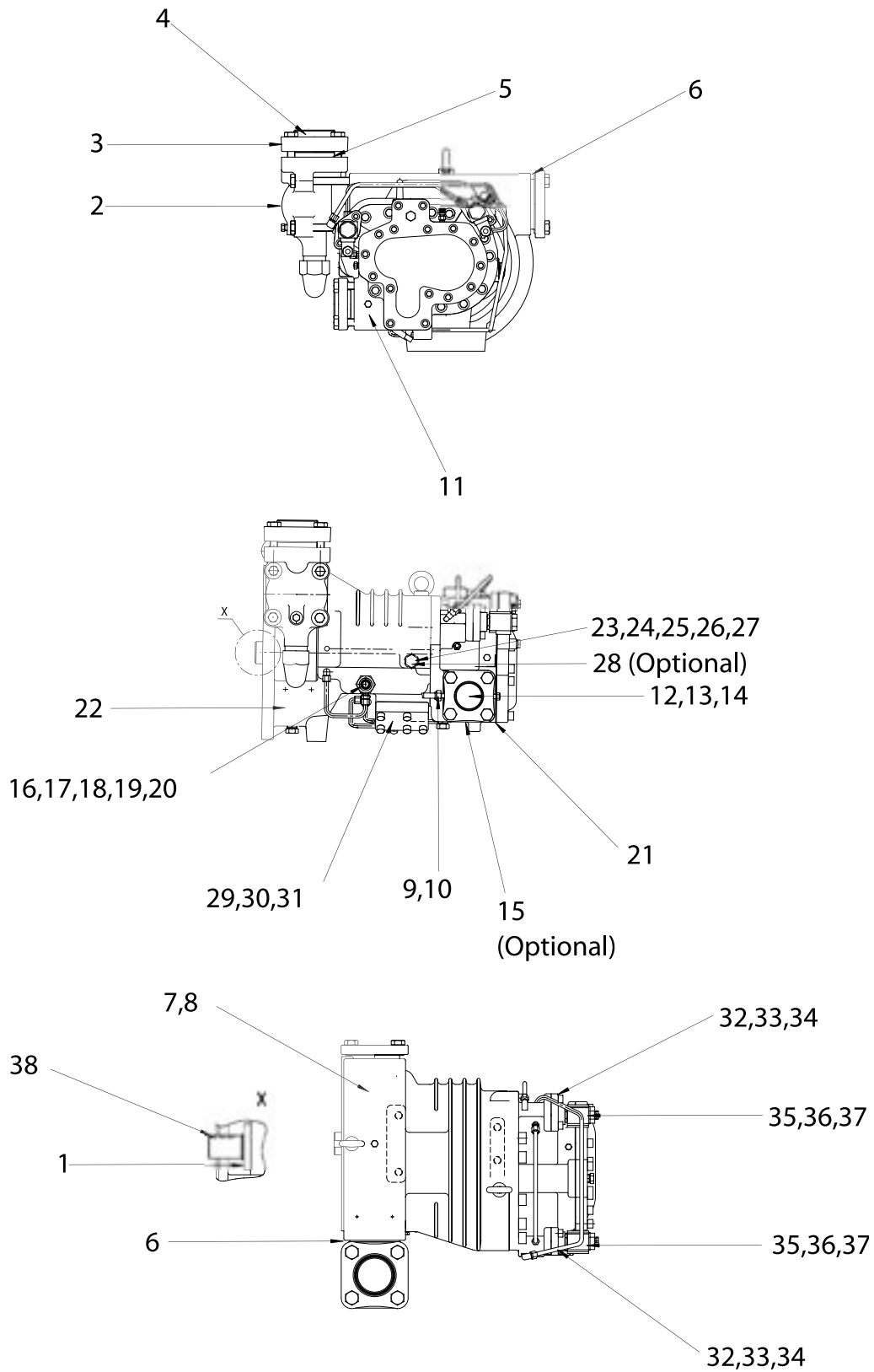
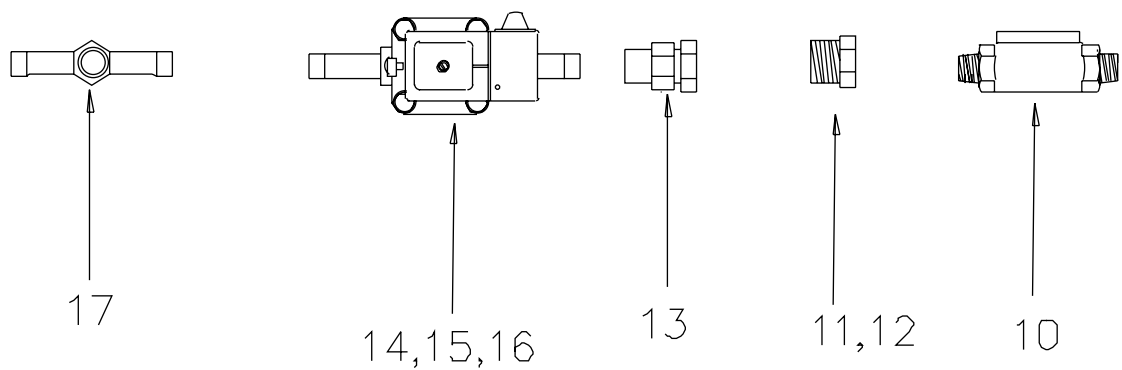
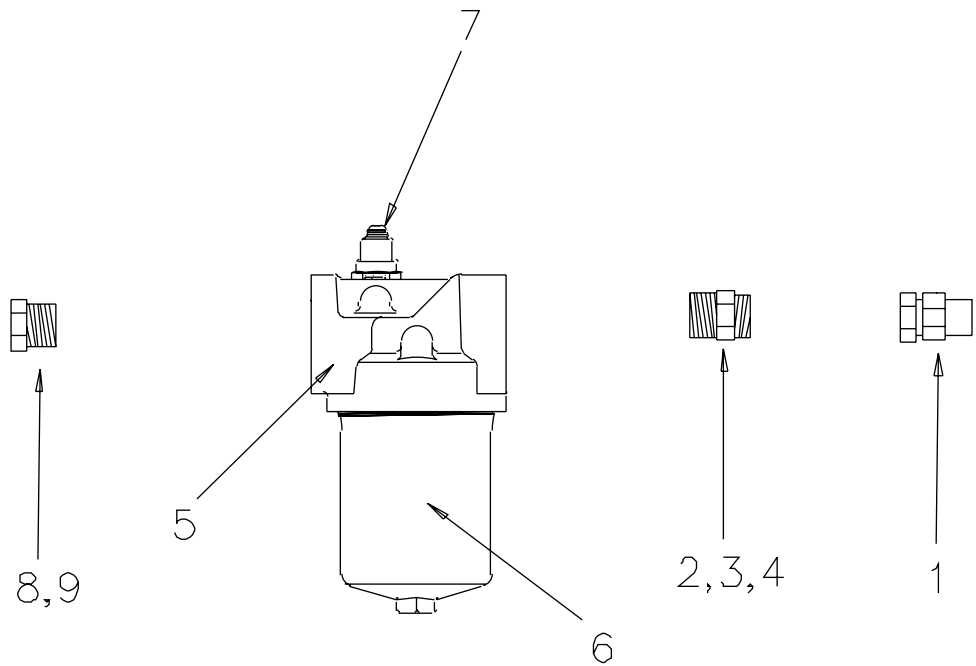

**Figure 12**  
 SDL1/SDM1 Compressors

**Figure 12**

**SDL1-0165     SDM1-0165**  
**SDL1-0192     SDM1-0192**  
**SDL1-0220     SDM1-0220**  
**SDL1-0250     SDM1-0250**

<b>Item #</b>	<b>Description</b>	<b>Copeland Part #</b>
1	Shaft Seal Complete	560-0004-12
2	3-1/8" Suction Service Valve	510-0428-04
3	3-1/8" Suction Valve Clamping Plate	003-1035-02
4	3-1/8" Solder Bushing	036-0832-02
5	Joint Ring Gasket for 3-1/8" Solder Bushing	020-0006-62
6	3-1/8" Suction Valve Gasket	020-0983-07
7	Suction Screen	013-0143-00
8	O-Ring for Suction Screen (Qty=2)	020-1072-00
9	PT1000 Discharge Temp Sensor (White)	085-0167-00
10	PTC 100 Discharge Temp Sensor (Red)	085-0164-01
11	Discharge Check Valve	510-0428-08
12	Joint Ring Gasket for 2-1/8" Discharge Solder Bushing	020-0983-06
13	2-1/8" Discharge Solder Bushing	036-0832-00
14	2-1/8" Discharge Clamping Plate	003-1035-01
15	2-1/8" Discharge Service Valve - Optional	510-0428-03
16	M22 Alumimun Washer for Oil Fitting	102-0147-00
17	M22 x 1.5 x 1-1/4"-12 UNF Screwed Socket for Oil	036-0724-20
18	Teflon O-Ring for Oil Screwed Socket	020-0006-64
19	Oil Solder Stub Connection	036-0724-22
20	Flare Nut for Oil Solder Connection 1-1/4"-12UNF	101-0010-25
21	Discharge/Bearing Cover Flange Gasket	020-0983-16
22	Covering Plate/Cover (Qty=2)	013-0144-00
23	M26 Alumimun Washer for ECO Fitting	102-0147-01
24	M26 x 1.5 UNF 1-1/4" St. ECO Screwed Socket	036-0724-10
25	Teflon O-Ring for ECO Socket	020-0006-64
26	ECO Solder Stub Connection	036-0934-00
27	Flare Nut for ECO Solder Conn 1-1/4"-12UNF	101-0010-25
28	ECO Fitting Kit-M26 (incls fitting, alum washer & o-ring)	536-0724-10
29	VI Control Piston	004-0420-01
30	Capacity Control Piston	004-0420-00
31	Cover Plate Gasket	020-0983-17
32	Unloader Stem Flange Gasket	020-0983-14
33	Unloader Flange	510-0428-01
34	Socket Screw for Unloader Flange	100-0409-00
35	24 Volt Unloader Solenoid Coil - 5/8"	023-0008-03
36	115 Volt Unloader Solenoid Coil - 5/8"	023-0008-00
37	230 Volt Unloader Solenoid Coil - 5/8"	023-0008-01
38	Shaft Key	075-0014-00
Not Shown	1-1/4" x 7/8" Roto-Lock Valve for Eco Fitting-Optional	510-0428-05
Not Shown	Gasket Set	560-0004-15
	2-1/8" Valve Kit (incls valve, gaskets & bolts)	510-0428-14
	3-1/8" Valve Kit (incls valve, gaskets & bolts)	510-0428-11

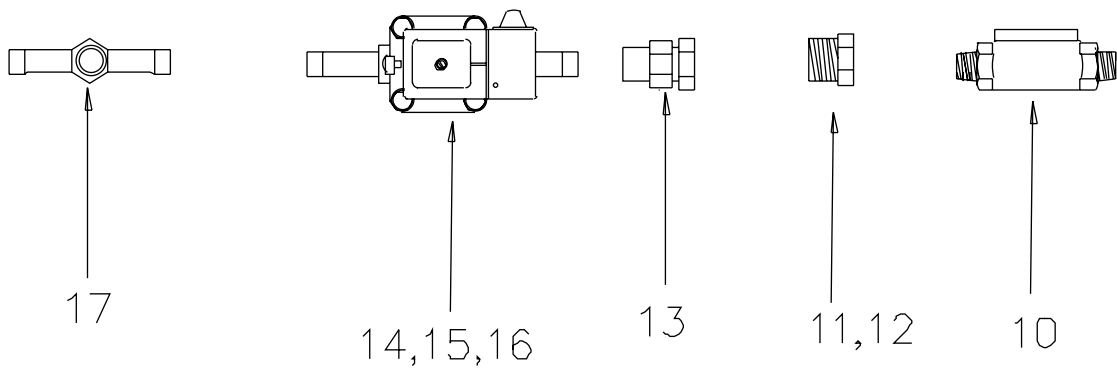
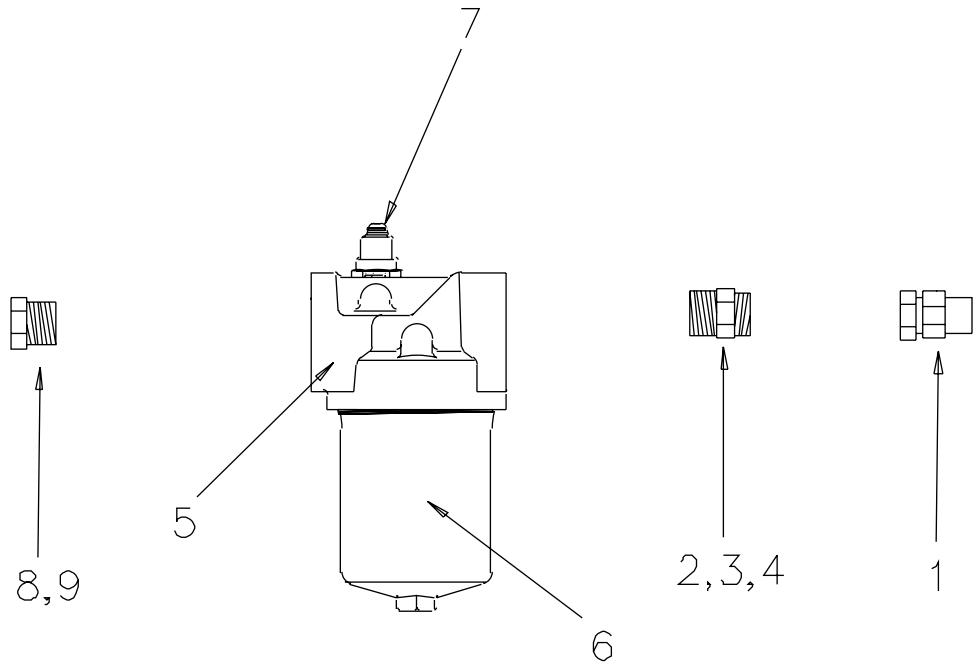

**Figure 13**  
Oil Circuit Component Diagram

**Oil Circuit Components**  
**Models: SHL SDL SHM SDM**  
**All Kits Shipped After April 2004**

**See Figure 13**

<b>Item #</b>	<b>Description</b>	<b>Copeland Part #</b>
1	1-1/4"-12 x 7/8" ODS Female Adapter	036-0815-00
2	1-1/4"-12 x 1" ODS Oil Filter Inlet Assembly	536-0724-14
3	1" Teflon O-Ring (included with item # 2)	020-0028-02
4	2-217-N674-70 Buna O-Ring (included with item # 2)	020-0003-52
5	Oil Filter Assembly (includes element)	036-0724-06
6	Replacement Oil Filter Element	013-0118-00
7	Oil Filter Differential Pressure Indicator (included with item # 5)	039-0010-00
8	3/8" FPT x 1" SAE Oil Filter Outlet Assembly	536-0820-00
9	2-217-N674-70 Buna O-Ring (included with item # 8)	020-0003-52
10	Oil Flow Switch	085-0164-07
11	3/8" FPT x 1" - 14 Adapter Oil Flow Switch Outlet	036-0956-00
12	1/2" Teflon O-Ring For Item # 13	020-0028-00
13	1" - 14 Female x 5/8" Sweat Roto-Lock Fitting	034-0025-00
14	5/8" Solenoid Valve	023-0008-02
15	110 Volt Solenoid Coil	023-0008-00
16	220 Volt Solenoid Coil	023-0008-01
17	5/8" Oil Sightglass	070-0019-00

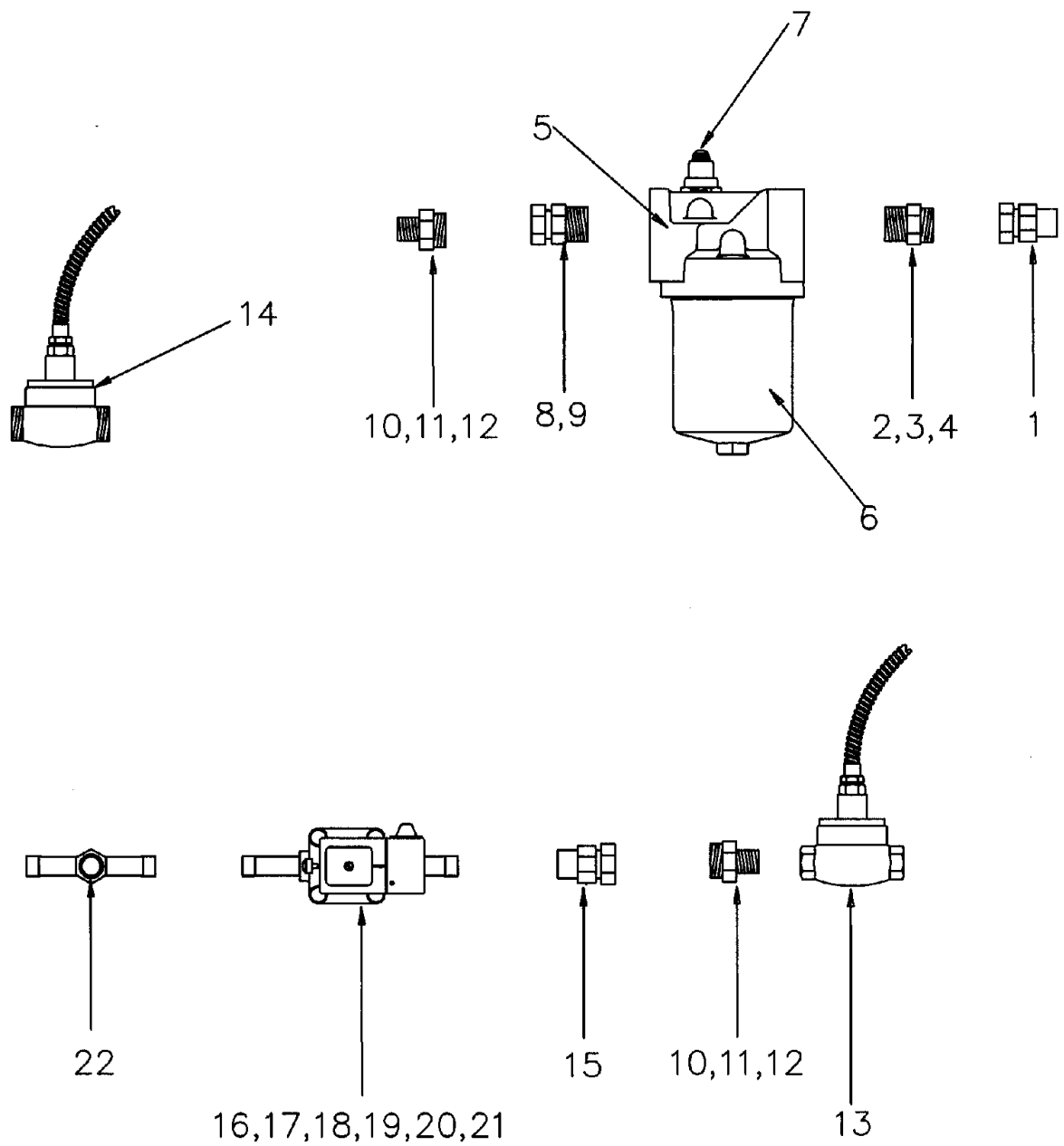

**Figure 14**  
Oil Circuit Component Diagram

**Oil Circuit Components**  
**Models: SHL SDL SHM SDM**  
**All Kits Shipped After April 2001**

**See Figure 14**

<b>Item #</b>	<b>Description</b>	<b>Copeland Part #</b>
1	1-1/4"-12 x 7/8" ODS Female Adapter	036-0815-00
2	1-1/4"-12 x 1" ODS Oil Filter Inlet Assembly	536-0724-14
3	1" Teflon O-Ring (included with item # 2)	020-0028-02
4	2-217-N674-70 Buna O-Ring (included with item # 2)	020-0003-52
5	Oil Filter Assembly (includes element)	036-0724-06
6	Replacement Oil Filter Element	013-0118-00
7	Oil Filter Differential Pressure Indicator (included with item # 5)	039-0010-00
8	3/8" FPT x 1" SAE Oil Filter Outlet Assembly	536-0820-00
9	2-217-N674-70 Buna O-Ring (included with item # 8)	020-0003-52
10	Oil Flow Switch	085-0164-07
11	5/8" ODS x 3/8" FPT Adapter	036-0821-00
12	5/8" Oil Solenoid Valve	023-0008-02
13	110 Volt Solenoid Coil	023-0008-00
14	220 Volt Solenoid Coil	023-0008-01
15	5/8" Oil Sightglass	070-0019-00

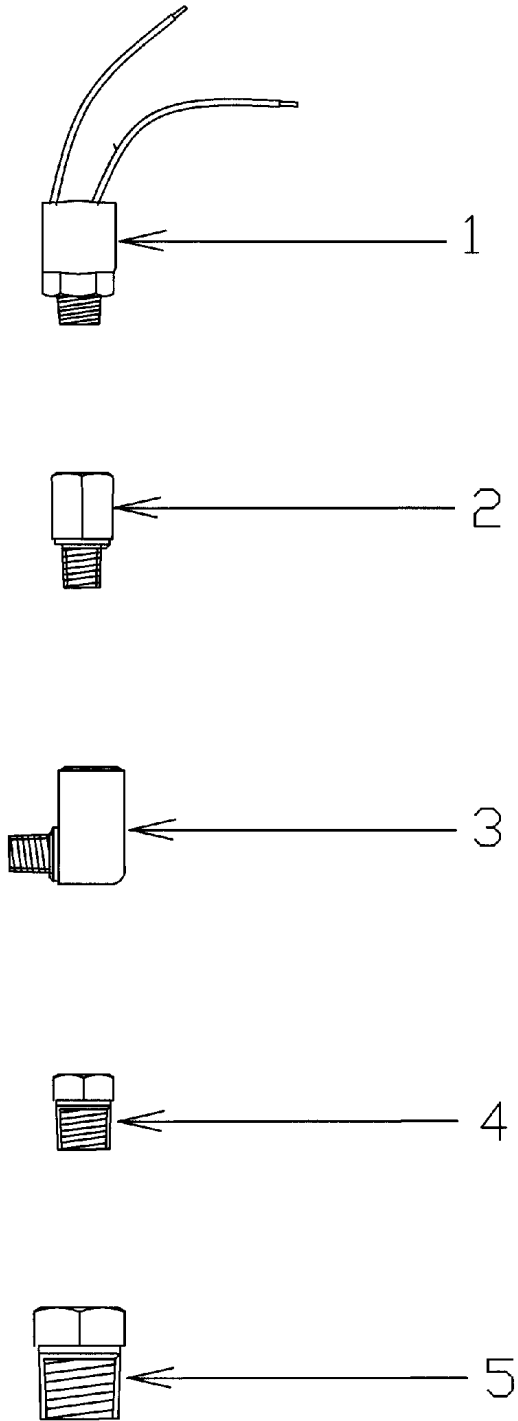

**Figure 15**  
Oil Circuit Component Diagram

**Oil Circuit Components**  
**Models: SHL SDL SHM SDM**  
**All Kits Shipped Prior To April 2001**

**See Figure 15**

<b>Item #</b>	<b>Description</b>	<b>Copeland Part #</b>
1	1-1/4"-12 x 7/8" ODS Female Adapter	036-0815-00
2	1-1/4"-12 x 1" ODS Oil Filter Inlet Assembly	536-0724-14
3	1" Teflon O-Ring (included with item # 2)	020-0028-02
4	2-217-N674-70 Buna O-Ring (included with item # 2)	020-0003-52
5	Oil Filter Assembly (includes element)	036-0724-06
6	Replacement Oil Filter Element	013-0118-00
7	Oil Filter Differential Pressure Indicator (included with item # 5)	039-0010-00
8	1"-14 Female x 1" SAE Male Straight Adapter	036-0724-15
9	2-217-N674-70 Buna O-Ring for item # 8	020-0003-52
10	1"-14 Male x 1/2" NPT Male Straight Adapter/Flow Switch In	036-0724-16
11	1"-14 Male x 1/2" NPT Male Straight Adapter/Flow Switch Out	036-0724-16
12	1/2" Teflon O-Ring for items 10 and 11	020-0028-00
13	Oil Flow Switch - Silver 64/74 Series	085-0164-02
14	Oil Flow Switch - Blue 53 Series	085-0164-03
15	1"-14 Female x 5/8" Sweat Female Straight Adapter	036-0724-04
16	Danfoss 5/8" Oil Solenoid Valve	023-0008-02
17	Danfoss 110 Volt Solenoid Coil	023-0008-00
18	Danfoss 220 Volt Solenoid Coil	023-0008-01
19	Parker 5/8" Oil Solenoid Valve	023-0030-00
20	Parker 110 Volt Solenoid Coil	023-0030-01
21	Parker 220 Volt Solenoid Coil	023-0030-02
22	5/8" Oil Sightglass	070-0019-00



**Figure 16**  
Rotation Switch Components

**Rotation Switch Components****See Figure 16**

<b>Item #</b>	<b>Description</b>	<b>Copeland Part #</b>
<b>SHL1(2)-20, 25, 30 HP and SHM1(2)-30, 35, 40 HP</b>		
1	Rotation Switch	071-0549-03
2	Vibration Damper	036-0724-23
3	1/8" Brass Street El	036-0724-01
4	1/8" x 3/8" MPT Brass Bushing	036-0724-08
<b>SHL1-40, 50 HP and SHM1-50, 60 HP</b>		
1	Rotation Switch	071-0549-03
2	Vibration Damper	036-0724-23
3	1/8" Brass Street El	036-0724-01
4	1/8" x 3/8" MPT Brass Bushing	036-0724-08
5	3/4" x 3/8" MPT Brass Bushing	036-0724-07
<b>SHL1-60, 70 HP and SHM1-70, 80 HP</b>		
1	Rotation Switch	071-0549-03
2	Vibration Damper	036-0724-23
3	1/8" Brass Street El	036-0724-01
<b>SHL1-75 HP and SHM1-90 HP</b>		
1	Rotation Switch	071-0549-03
2	Vibration Damper	036-0724-23
3	1/8" Brass Street El	036-0724-01
4	1/8" x 3/8" MPT Brass Bushing	036-0724-08
<b>SDL1 (SDM1) - 0084, 0100, 0118</b>		
1	Rotation Switch	071-0549-03
2	Vibration Damper	036-0724-23
3	1/8" x 3/8" MPT Brass Bushing	036-0724-08
<b>SDL1 (SDM1) - 0165, 0192, 0220, 0250</b>		
1	Rotation Switch	071-0549-03
2	Vibration Damper	036-0724-23
3	1/8" Brass Street El	036-0724-01
4	1/8" x 3/8" MPT Brass Bushing	036-0724-08

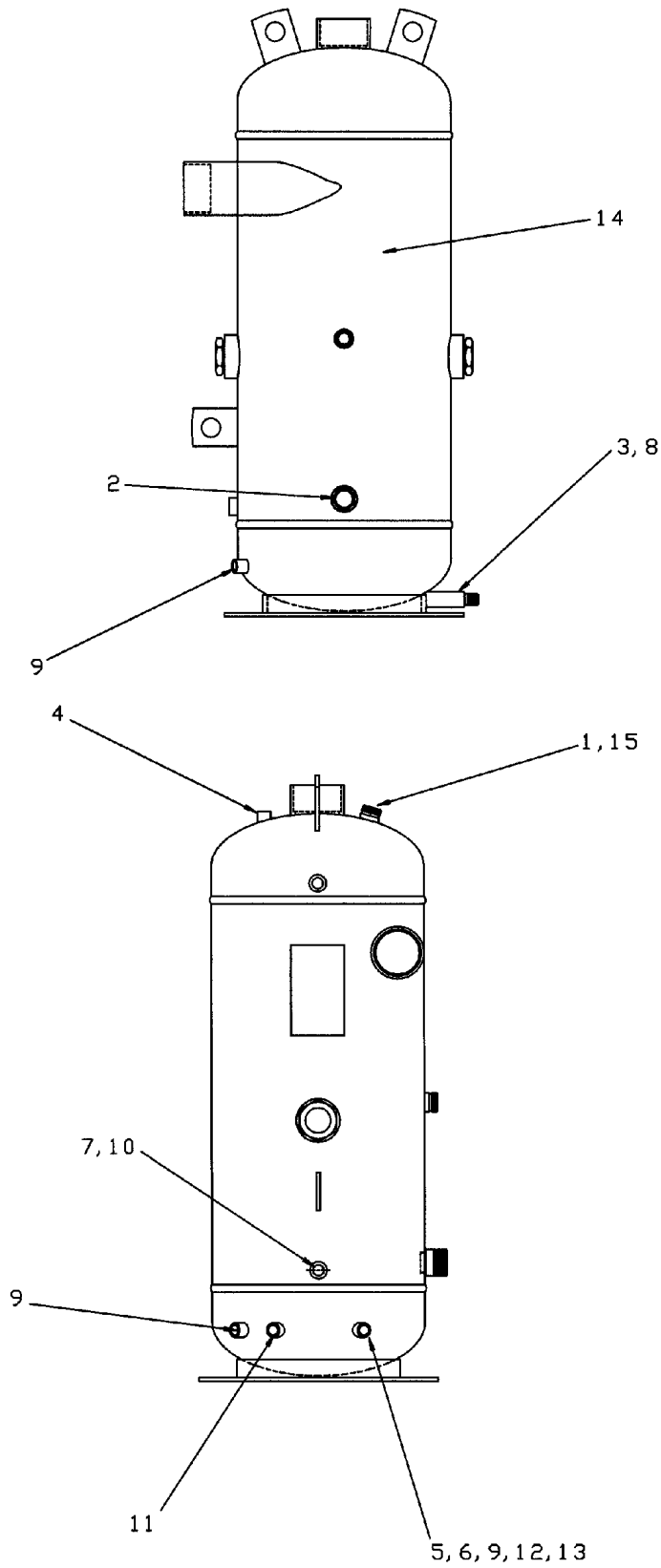
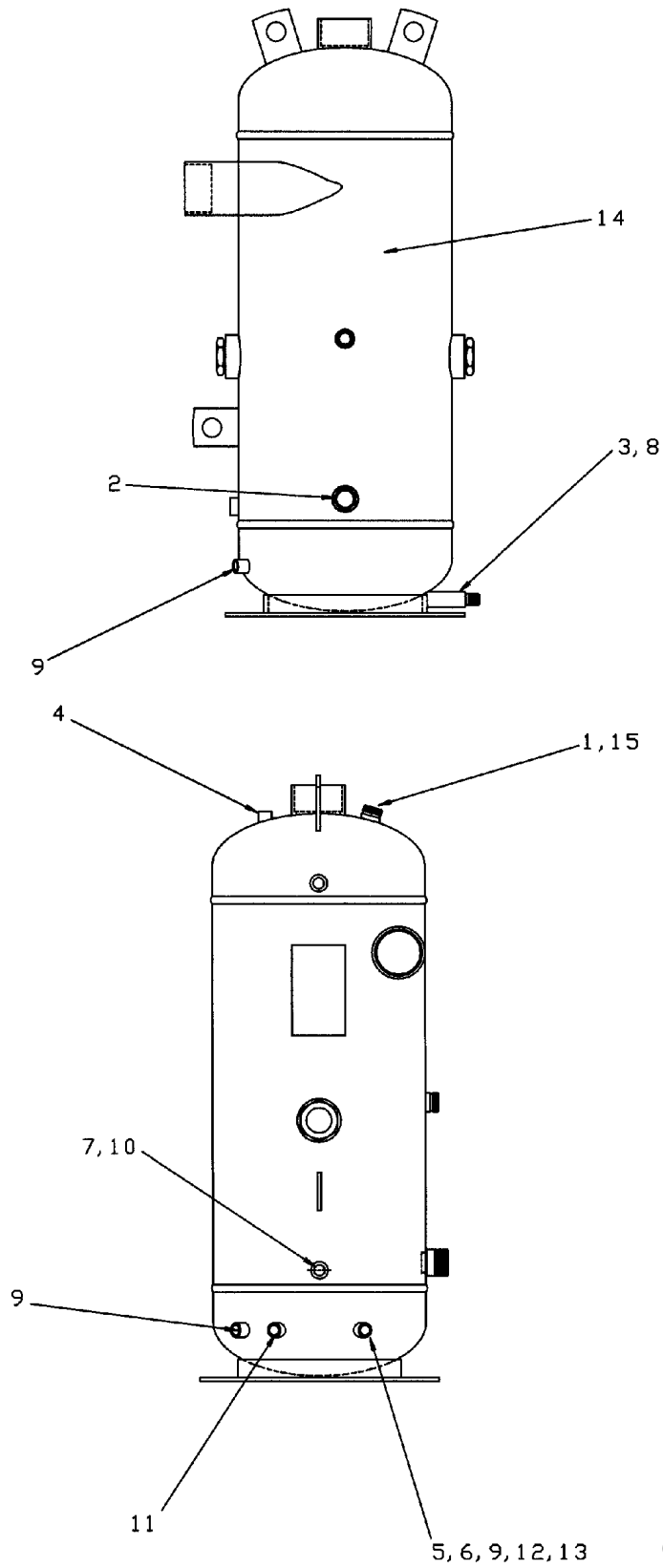

**Figure 17**  
Oil Separator Components

## Oil Separator Component Parts

## Figure 17

Item #	Description	Copeland Part #
<b>18 Liter (OA 1854) 560-0003-02 and 03</b>		
1	1-1/4" x 12 Rotalock Cap Seal	005-0929-02
2	Valve - Sweat 1-1/4"-12 x 7/8"	010-0049-03
3	Valve - 3/4" Vertical Rotalock	010-0049-05
4	Valve - Transducer	010-0049-06
5	Heater - 70 Watt 115 Volt	018-0051-01
6	Heater - 70 Watt 230 Volt	018-0051-02
7	Seal O-Ring	020-0983-20
8	Seal - 1/2" Teflon O-Ring	020-0028-00
9	Sleeve - Heater 70/100 Watt	030-0196-00
10	Optical Sensor - Oil Level Switch	071-0549-02
11	Control - Heater Thermostat	085-0164-09
12	Heater - 100 Watt 115 Volt	018-0058-00
13	Heater - 100 Watt 230 Volt	018-0058-01
14	Separator Vessel - 18 Liter	077-0020-00
15	1-1/4"-12 Rotalock Cap	005-1038-00
16	1-1/4" Rotalock Sight Glass - Vessels After 1 April 2002	070-0019-01
<b>40 Liter (OA 4088) 560-0003-04 and 05</b>		
1	1-1/4" x 12 Rotalock Cap Seal	005-0929-02
2	Valve - Sweat 1-3/4"-12 x 1-3/8"	010-0049-04
3	Valve - 3/4" Vertical Rotalock	010-0049-05
4	Valve - Transducer	010-0049-06
5	Heater - 70 Watt 115 Volt	018-0051-01
6	Heater - 70 Watt 230 Volt	018-0051-02
7	Seal O-Ring	020-0983-20
8	Seal - 1/2" Teflon O-Ring	020-0028-00
9	Sleeve - Heater 70/100 Watt	030-0196-00
10	Optical Sensor - Oil Level Switch	071-0549-02
11	Control - Heater Thermostat	085-0164-09
12	Heater - 100 Watt 115 Volt	018-0058-00
13	Heater - 100 Watt 230 Volt	018-0058-01
14	Separator Vessel - 40 Liter	077-0020-01
15	1-1/4"-12 Rotalock Cap	005-1038-00
16	1-1/4" Rotalock Sight Glass - Vessels After 1 April 2002	070-0019-01



**Figure 18**  
Oil Separator Components

## Oil Separator Component Parts

## Figure 18

Item #	Description	Copeland Part #
<b>90 Liter (OA 9011) 560-0003-06 and 07</b>		
1	1-1/4" x 12 Rotalock Cap Seal	005-0929-02
2	Valve - Sweat 1-3/4"-12 x 1-3/8"	010-0049-04
3	Valve - 3/4" Vertical Rotalock	010-0049-05
4	Valve - Transducer	010-0049-06
5	Heater - 70 Watt 115 Volt	018-0051-01
6	Heater - 70 Watt 230 Volt	018-0051-02
7	Seal O-Ring	020-0983-20
8	Seal - 1/2" Teflon O-Ring	020-0028-00
9	Sleeve - Heater 70/100 Watt	030-0196-00
10	Optical Sensor - Oil Level Switch	071-0549-02
11	Control - Heater Thermostat	085-0164-09
12	Heater - 100 Watt 115 Volt	018-0058-00
13	Heater - 100 Watt 230 Volt	018-0058-01
14	Separator Vessel - 90 Liter	077-0020-03
15	1-1/4"-12 Rotalock Cap	005-1038-00
16	1-1/4" Rotalock Sight Glass - Vessels After 1 April 2002	070-0019-01
<b>140 Liter (OA 14011) 560-0003-08 and 09</b>		
1	1-1/4" x 12 Rotalock Cap Seal	005-0929-02
2	Valve - Sweat 1-3/4"-12 x 1-3/8"	010-0049-04
3	Valve - 3/4" Vertical Rotalock	010-0049-05
4	Valve - Transducer	010-0049-06
5	Heater - 70 Watt 115 Volt	018-0051-01
6	Heater - 70 Watt 230 Volt	018-0051-02
7	Seal O-Ring	020-0983-20
8	Seal - 1/2" Teflon O-Ring	020-0028-00
9	Sleeve - Heater 70/100 Watt	030-0196-00
10	Optical Sensor - Oil Level Switch	071-0549-02
11	Control - Heater Thermostat	085-0164-09
12	Heater - 100 Watt 115 Volt	018-0058-00
13	Heater - 100 Watt 230 Volt	018-0058-01
14	Separator Vessel - 140 Liter	077-0020-02
15	1-1/4"-12 Rotalock Cap	005-1038-00
16	1-1/4" Rotalock Sight Glass - Vessels After 1 April 2002	070-0019-01

## Open Drive Screw Compressor Coupling Kits

Model Number	Copeland Part #
SDL1/SDM1-0084	560-0004-08/09
SDL1/SDM1-0100	560-0004-08/09
SDL1/SDM1-0118	560-0004-08/09
SDL1/SDM1-0165	560-0004-10/11
SDL1/SDM1-0192	560-0004-10/11
SDL1/SDM1-0220	560-0004-10/11
SDL1-0250	560-0004-10/11/18
SDM1-0250	560-0004-10/11/18

Motor Frame Sizes			
Copeland Part #	Frame Size	Shaft $\Phi$	Shaft Length
560-0004-08	284TSC-286TSC	1-5/8"	3"
560-0004-09	324TSC-326TSC	1-7/8"	3-1/2"
560-0004-10	324TSC-326TSC	1-7/8"	3-1/2"
560-0004-11	405TSC	2-1/8"	4"
560-0004-18	365TSC	1-7/8"	3-1/2"

Connection Sizes		
Compressor	Suction	Discharge
SHL2-2000, 2500, 3000	2 1/8	1 5/8
SHL1-4000, 5000	2 1/8	1 5/8
SHL1-6000, 7000, 7500	3 1/8	2 1/8
SHM2-3000, 35000, 4000	2 1/8	1 5/8
SHM1-5000, 6000	2 1/8	1 5/8
SHM1-7000, 8000, 9000	3 1/8	2 1/8
SDL1-0084, 0100, 0118	2 1/8	1 5/8
SDL1-0165, 0192, 0220, 0250	3 1/8	2 1/8
SDM1-0084, 0100, 0118	2 1/8	1 5/8
SDM1-0165, 0192, 0220, 0250	3 1/8	2 1/8
SCH2-5000, 6000	2 1/8	1 5/8
SCH2-7000, 8000, 9000	3 1/8	2 1/8
SCH2-11H0, 12H0, 14H0	4 1/8	3 1/8
SCH2-18H0, 21H0, 24H0	4 1/8	3 1/8
SCA2-350E, 400E	2 1/8	1 5/8
SCA2-500E, 600E, 700E	3 1/8	2 1/8
SCA2-801E, 901E	3 1/8	2 1/8
SCA2-800E, 900E, 11HE, 12HE, 14HE	4 1/8	3 1/8
SCA2-16HE, 1 8HE, 21HE, 24HE	5	4 1/8

Screw Compressor Oil			
SHL, SHM, SCA, SCH with HFC	SOLEST 170	998-E170-01	1 gallon
SHL, SHM, SCA, SCH with HFC	SOLEST 170	998-E170-05	5 gallon
SHL, SHM with R-22	BVA A100EP	998-A100-01	1 gallon
SHL, SHM with R-22	BVA A100EP	998-A100-05	5 gallon
SCH with R-22	BVA 4214-320	998-E320-01	1 gallon
SCH with R-22	BVA 4214-320	998-E320-05	5 gallon

# Notes

---

Form No. 2001-141 R3

Revised 8/04

© 2004, 2002 Copeland Corporation

Printed in the U.S.A.

The Emerson logo is a trademark and service mark of Emerson Electric Co.

Copeland and the Copeland Screw logo are registered trademarks of Copeland Corporation.